



Honda CBF 600 (2004)

Slip-On SP Series Exhaust System

Akrapovic Slip-On SP Series Exhaust System

for the Honda CBF 600 (2004)

The Akrapovic SLIP-ON SP SERIES is intended for riders who do not wish to make any drastic changes to their exhaust system. It is a more cost-effective version of the Akrapovic SLIP-ON line, and features identical performance. The difference is in the materials, as the SP series is made entirely of high-quality stainless steel, except for the titanium muffler outer sleeve. Another important advantage of this system is that it is approved for street use, as confirmed by the laser engraving on the muffler.

PERFORMANCE

Measurements of the Akrapovic SLIP-ON SP SERIES system on the HONDA CBF 600 (without noise damper):

Power: the Honda engine responds well to the change in the exhaust system. It shows up as a power increase which grows at the top of the rpm range and tops out at 73.7 HP at 10700 rpm. The increase of 4.5 HP is very respectable for a basic-level exhaust tuning.

Torque: the torque curve also receives a boost. There is an increase throughout the entire rpm range, which contributes to more relaxed riding.

CONFIGURATION

The system is composed of a cylindrical stainless steel link pipe, which is attached to the stock header assembly with a free-floating joint secured with a metal clamp and silicon-shielded tensioning springs. The connection to the muffler is also a free-floating joint, secured with silicon-shielded tensioning springs. The muffler has an SP series interior, with a stainless steel inlet and outlet cap, while the outer sleeve is made entirely of titanium. The muffler has a built-in noise damper so that it conforms to all regulations for exhaust systems in road traffic.

	PERFORMANCE		
	stock	AKRAPOVIC	max. increased power
max. rear wheel power HP / rpm (measured on SuperFlow Cycle Dyn)	69.2 / 10700	73.7 / 10700	5 / 11000

	CONFIGURATION		
	header tubes	collector	link pipe
material	-	-	STAINLESS STEEL
tube shape	-	-	CYLINDRICAL

interference crossover tubes	-	lambda sensor	-
header tube inner sleeves	-	header tube flanges	-
header tubes - collector connection	-	collector / header tube - link pipe connection	FREE-FLOATING + SILICON SHIELDED SPRING+ METAL CLAMP
link pipe - muffler connection	FREE-FLOATING + SILICON SHIELDED SPRINGS	muffler inlet cap /outlet cap	STAINLESS STEEL/ STAINLESS STEEL
muffler metal interior	STAINLESS STEEL	muffler outer sleeve	TITANIUM
muffler clamp	CARBON-FIBER ROAD	muffler bracket	-
noise damper	HOMOLOGATED	heat shield	-

OPTIONS				
link pipe	noise damper	muffler outer sleeve	muffler bracket	heat shield
-	-	-	-	-

	ADDITIONAL DATA				
	stock	AKRAPOVIC		difference	
		S.S. link pipe	TITANIUM link pipe	stock - S.S.	stock - titanium
weight comparison (kg)	4.60	2.33	-	2.27	-
noise measurements (dB / rpm)	stock		AKRAPOVIC		
	90 / 5250		90 / 5250		
possibility of periodic service without removing A.E.S.	oil		oil filter		
	YES		YES		
legal for street use	YES				

Technical specifications of Akrapovic exhaust systems and related products subject to change without notice.

Akrapovic Exhaust System Technology copyright 2004, all rights reserved

Road Program



Akrapovic Slip-On SP Series Exhaust System for the Honda CBF 600 (2004)



CARBON-FIBER
MUFFLER CLAMP

Road
Program

Akrapovic Slip-On SP Series Exhaust System for the Honda CBF 600 (2004)



Akrapovic Exhaust System Technology copyright 2004, all rights reserved

Road
Program

Akrapovic Slip-On SP Series Exhaust System for the Honda CBF 600 (2004)



Akrapovic Exhaust System Technology copyright 2004, all rights reserved

Road Program

Product code: 102896 (SS-H6SO7-HT)



Akrapovic Slip-On SP Series Exhaust System

for the Honda CBF 600 (2004)

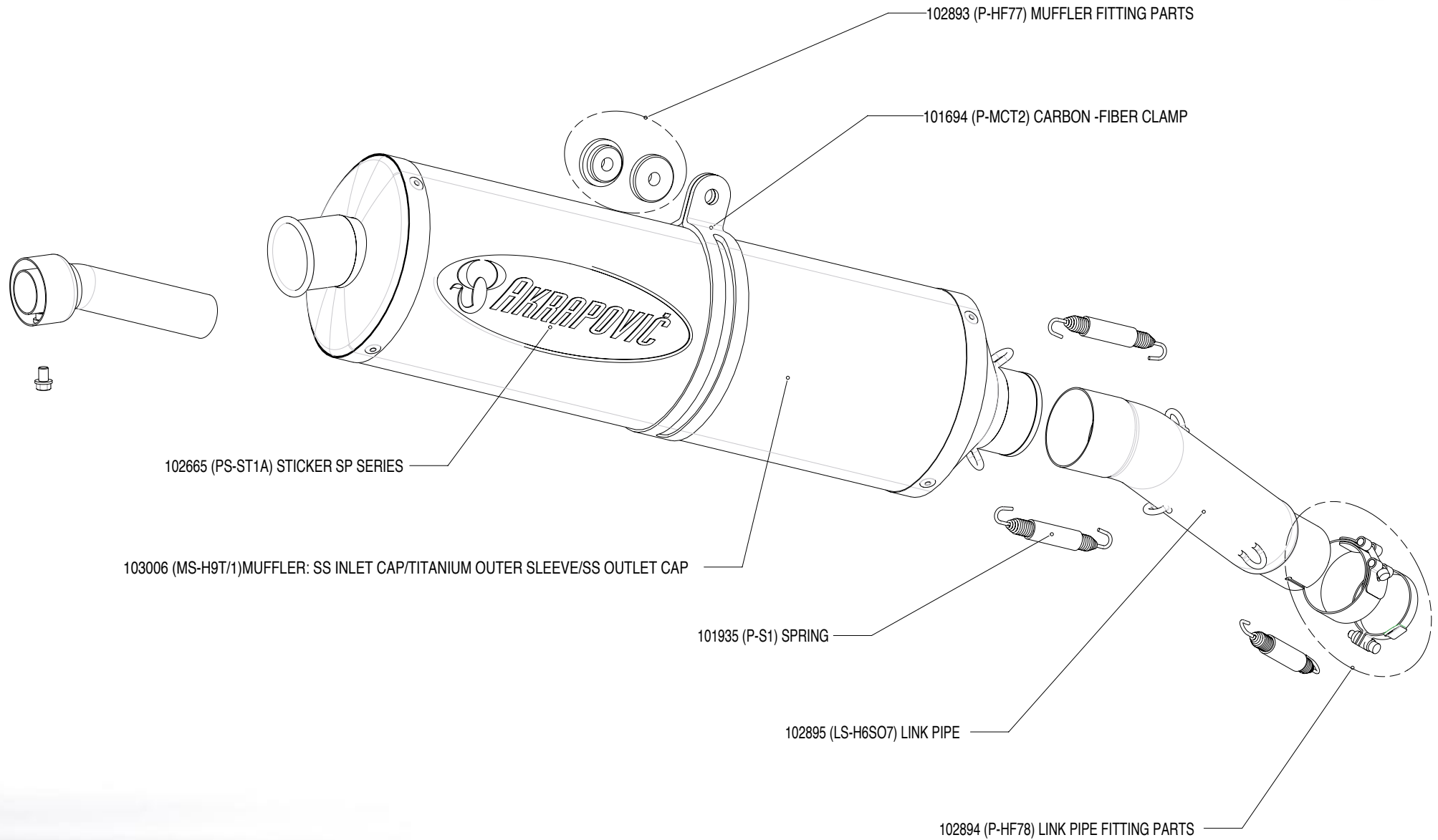

Akrapovic Exhaust System Technology copyright 2004, all rights reserved

Road Program



Akrapovic Slip-On SP Series Exhaust System

for the Honda CBF 600 (2004)

AKRAPOVIC SLIP-ON SP series EXHAUST
(without noise damper)

STOCK EXHAUST

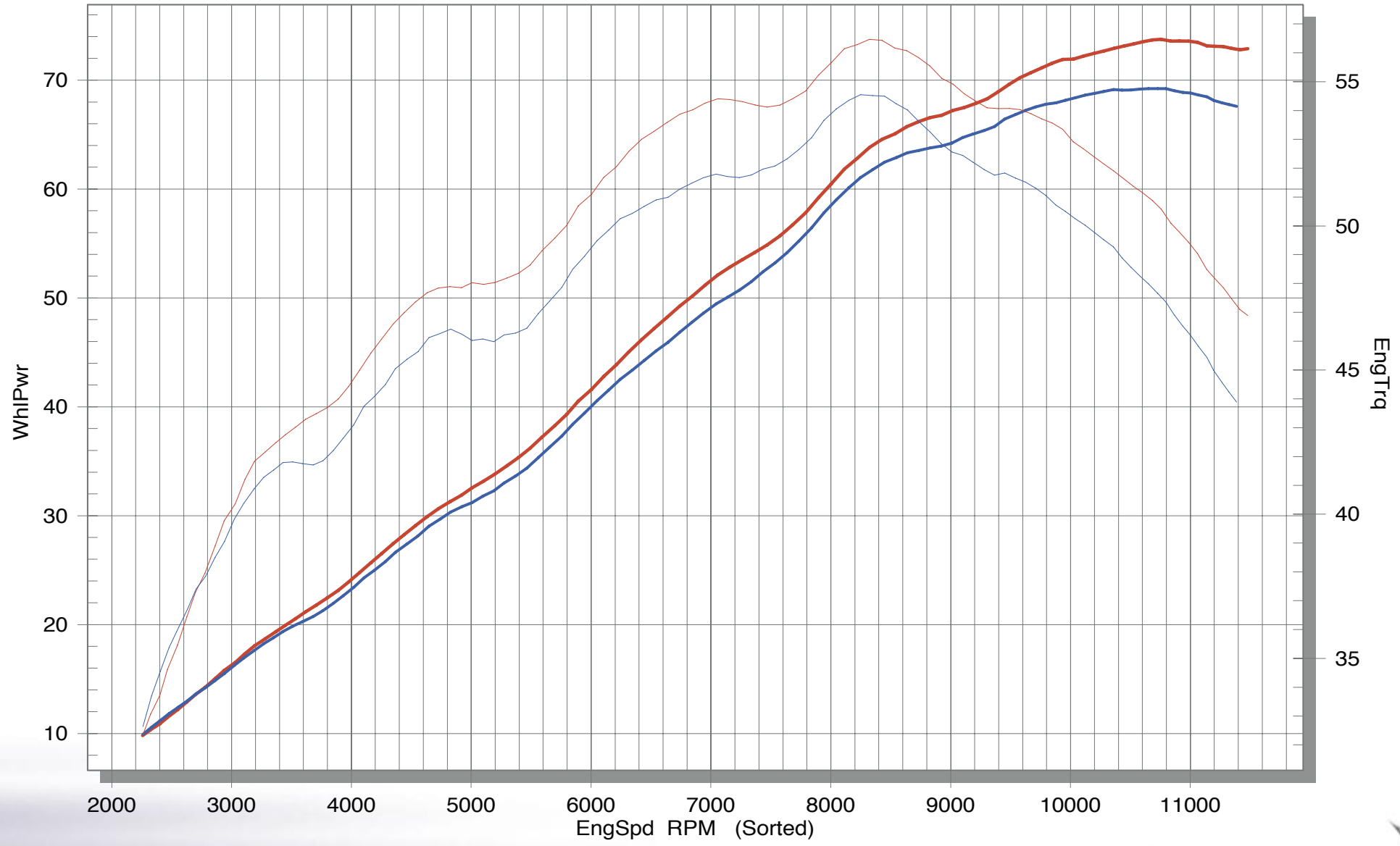

Road Program



Akrapovic Exhaust System Technology copyright 2004, all rights reserved