



HONDA CBF 1000 (2008)

(2008)

www.akrapovic.com

AKRAPOVIC SP SERIES SLIP-ON STREET LEGAL EXHAUST SYSTEM
AKRAPOVIC SP SERIES SLIP-ON OPEN EXHAUST SYSTEM

The Akrapovic SLIP-ON exhaust system is designed for riders who want to upgrade the looks and performance of their bikes at an affordable price, without making a major modification. This system officially conforms to all exhaust system noise level regulations for street use.

PERFORMANCE

Measurements of the Akrapovic SLIP-ON system on the HONDA CBF 1000 RR (without muffler insert):

Power & Torque: The SLIP-ON system offers a performance increase throughout the entire rpm range. At 7750 rpm we measured 89.8 HP. The situation for the torque curve is similar, with the best results coming in the middle of the range around 5000 rpm, where the dropout in the stock curve is filled.

CONFIGURATION

The Akrapovic SLIP-ON exhaust system is made of two mufflers and stainless steel link pipes. The independent link pipe is attached to the stock header assembly with a sleeve joint, secured with a metal clamp. The link pipe and muffler are connected with a sleeve joint, which is secured with a silicon-shielded springs. The muffler outer sleeve is made of titanium. The muffler is attached to the frame using an Akrapovic carbon fiber clamp. The system includes catalytic converter and a noise damper installed in the muffler.

	PERFORMANCE		
	stock	AKRAPOVIC	max. increased power
max. rear wheel power HP / rpm (measured on Dynojet ATV)	88.4 / 7650	89.8 / 7750	3.8 / 9600

	CONFIGURATION		
	header tubes	collector	link pipe
material	-	-	STAINLESS STEEL
tube shape	-	-	CONICAL

interference crossover tubes	-	lambda sensor	-	
header tube inner sleeves	-	header tube flanges	-	
header tubes - collector connection	-	collector / header tube - link pipe connection	SLEEVE JOINT+ GRAPHITE GASKET+ METAL CLAMP	
link pipe - muffler connection	SLEEVE JOINT+ SILICON SHIELDED SPRING	muffler inlet cap /outlet cap	STAINLESS STEEL / STAINLESS STEEL	
muffler metal interior	STAINLESS STEEL	muffler outer sleeve	TITANIUM	
muffler clamp	CARBON-FIBER	muffler bracket	-	
muffler insert	EU	NOISE DAMPER	heat shield	NO
	US	-	catalytic converter	YES (MUFF.- LP joint)

	ADDITIONAL DATA				
	stock	AKRAPOVIC		difference	
		S.S. link pipe	TITANIUM link pipe	stock - S.S.	stock - titanium
weight comparison (kg)	9.5	4.91	-	4.59	-

	stock	AKRAPOVIC
	noise measurements (dB / rpm)	88 / 4000
possibility of periodic service without removing A.E.S.	oil	oil filter
	YES	YES
legal for street use	YES / NO	

Technical specifications of Akrapovic exhaust systems and related products subject to change without notice.



Product code: SS-H10SO5-HST (109662)
SS-H10SO5-ST (109682)



Product code: SS-H10SO5-HST (109662)
SS-H10SO5-ST (109682)



Product code: SS-H10SO5-HST (109662)
SS-H10SO5-ST (109682)

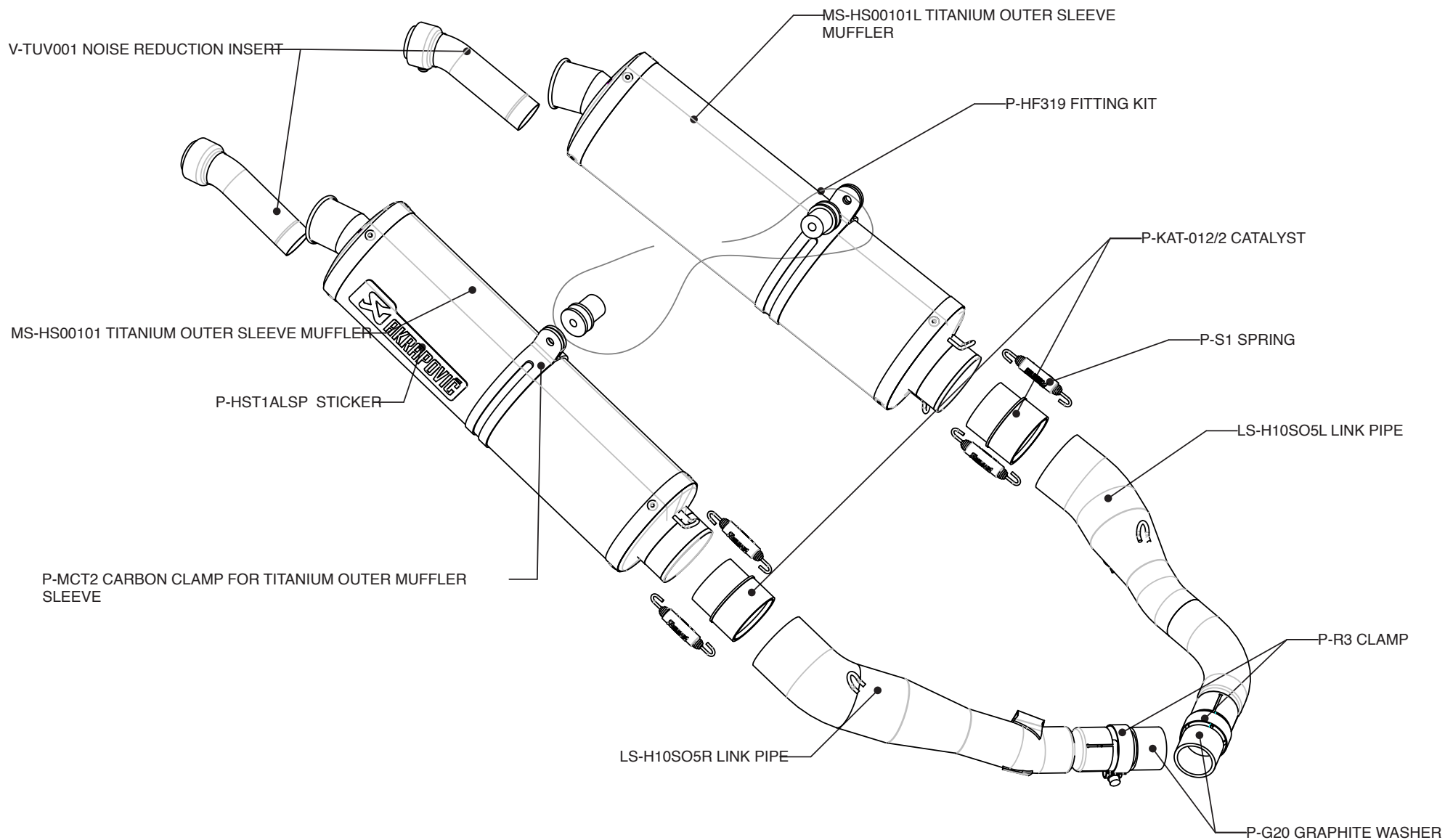

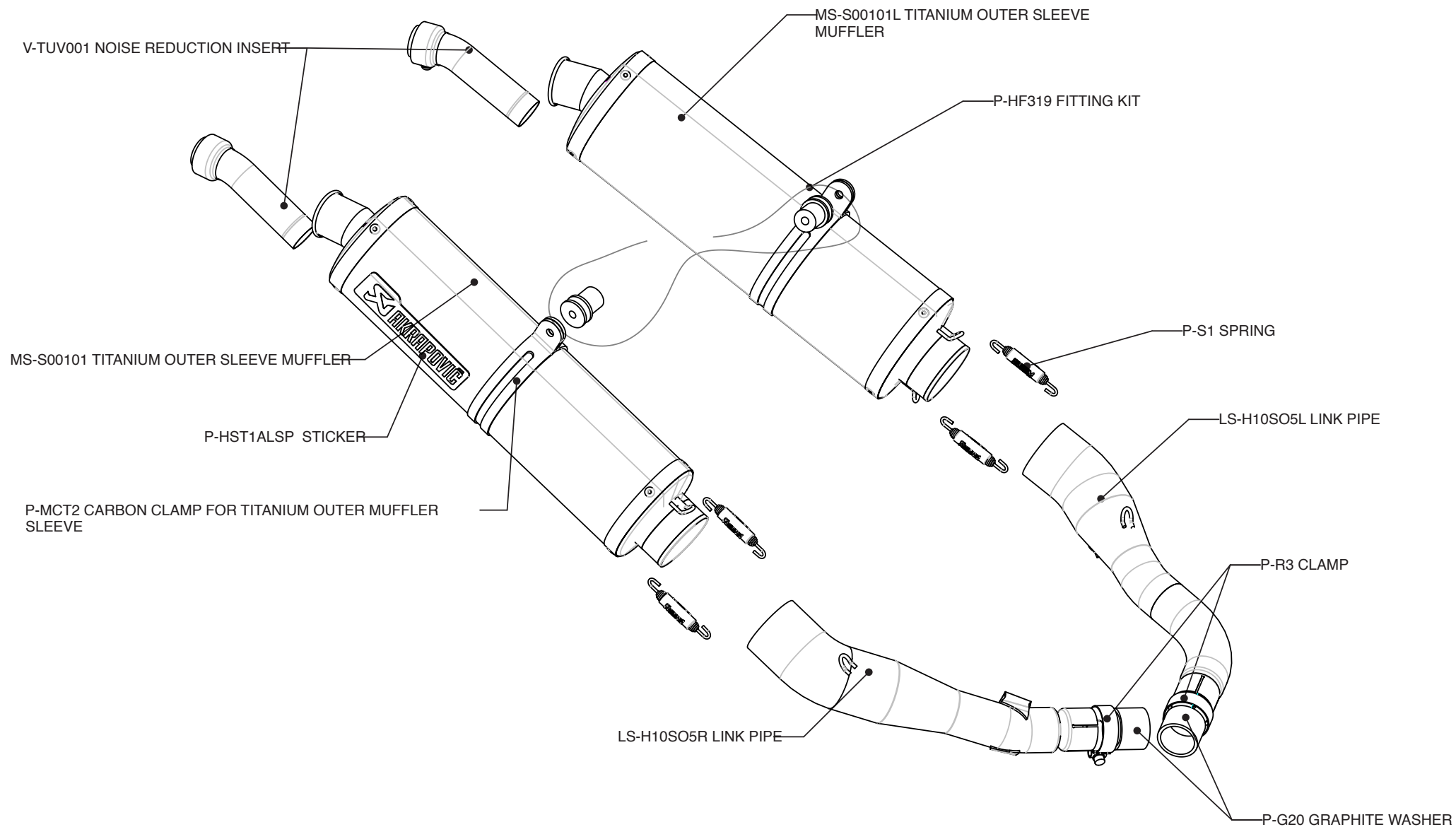

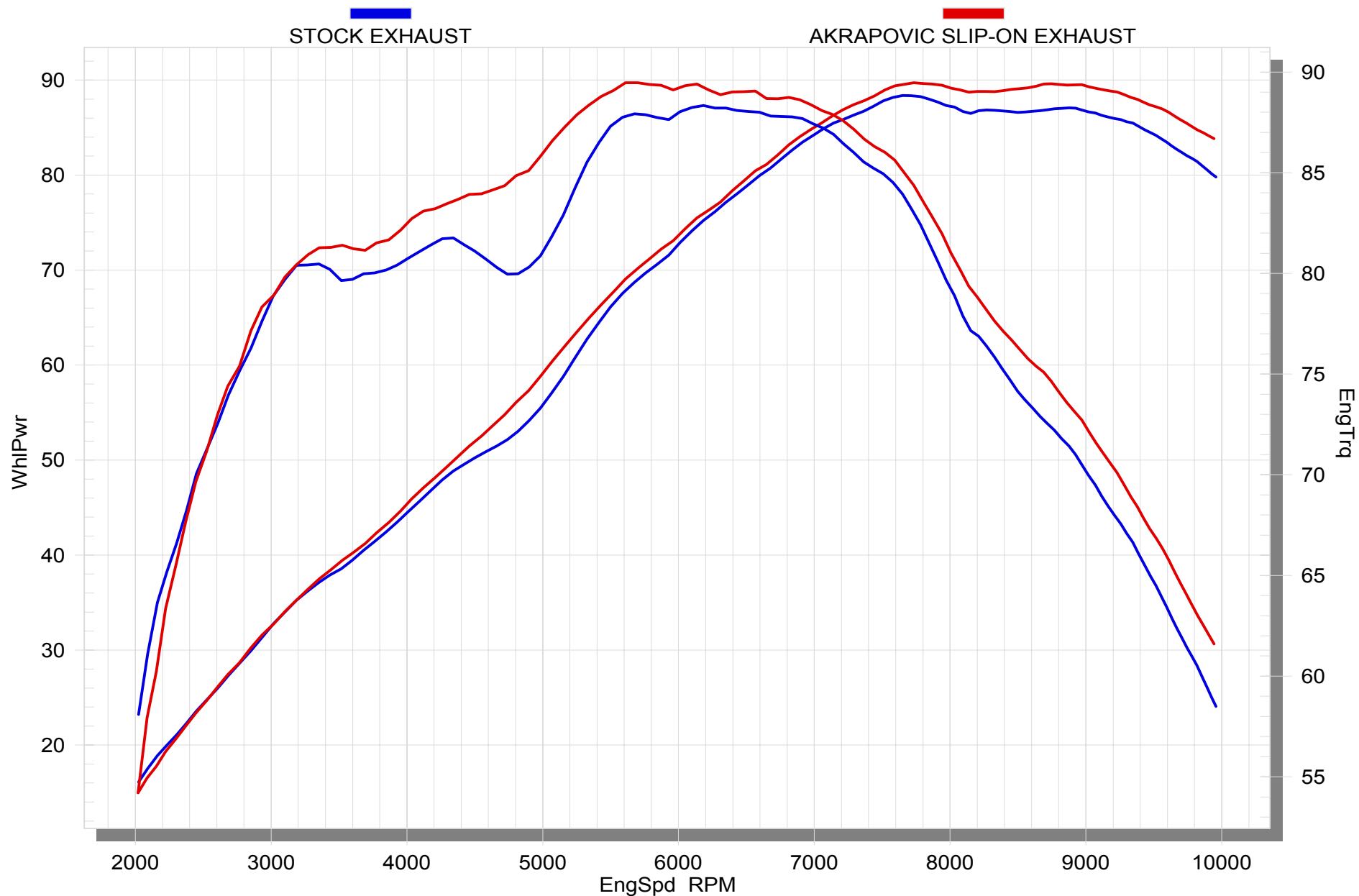

Product code: SS-H10SO5-HST (109662)
 SS-H10SO5-ST (109682)



www.akrapovic.com
 Akrapović d.d. 2008 all rights reserved