



**HONDA CRF 250R**

**(2008)**

**SLIP-ON EXHAUST SYSTEM**

[www.akrapovic.net](http://www.akrapovic.net)

The Akrapovic Slip-On system is designed for recreational riders. It delivers an excellent combination of quality, performance, visual enhancement, easy installation and affordability. The Akrapovic Slip-On is designed for two markets; in the US it is available with an approved spark arrester, and for the EU and other non-US markets it comes with a noise damper.

**PERFORMANCE**

**Measurements of the Akrapovic SLIP-ON system on the HONDA CRF 250R (with muffler inserts):**

Power & Torque: the engine reacts to the change of the exhaust system by increasing the value of power and torque, which is noticeable through entire rpm range. We measured max. power increase of 1.3 HP at 6600 rpm.

**CONFIGURATION**

The twin-pipe Akrapovic SLIP-ON system for the Honda CRF is composed of titanium mufflers and exceptionally short cylindrical stainless steel link pipes, which are welded to the mufflers. At the other end the link pipes are attached to the header assembly using sleeve joints held together with metal clamps and silicon-shielded springs. The mufflers are attached to the frame using Akrapovic offroad carbon-fiber clamps. The mufflers are available with titanium outer sleeves, with titanium outlet caps, while the inlet caps and perforated inner sleeves are made of stainless steel. The mufflers have noise dampers for the European and other non-American markets, while for the US market they are equipped with spark arresters.

	PERFORMANCE		
	stock	AKRAPOVIC	max. increased power
max. rear wheel power HP / rpm <small>(measured on Dynojet ATV)</small>	34.3 \ 11170	34.5 \ 10870	1.3 \ 6600

	CONFIGURATION		
	header tubes	collector	link pipe
material	-	-	STAINLESS STEEL
tube shape	-	-	CYLINDRICAL

interference crossover tubes	-	lambda sensor	NO
header tube inner sleeves	-	header tube flanges	-
header tubes - collector connection	-	collector / header tube - link pipe connection	SLEEVE JOINT + SILICON SHIELDED SPRING + METAL CLAMP+HOOK+ METAL CLAMP
link pipe - muffler connection	WELDED	muffler inlet cap /outlet cap	S.S. \ Ti
muffler metal interior	STAINLESS STEEL	muffler outer sleeve	TITANIUM
muffler clamp	CARBON-FIBER	muffler bracket	-
muffler insert	EU	YES	heat shield
	US	YES	catalytic converter

	ADDITIONAL DATA				
	stock	AKRAPOVIC		difference	
		S.S. link pipe	Ti link pipe	stock - S.S.	stock - Ti
weight comparison (kg)	2-36	2.03	-	0.33	-
noise measurements (dB / rpm)	stock		AKRAPOVIC		
	94 / 5000		94 / 5000		
possibility of periodic service without removing A.E.S.	oil		oil filter		
	YES		YES		
legal for street use	NO				

Technical specifications of Akrapovic exhaust systems and related products subject to change without notice.



Product code: (105142) S-H2SO2-MT – MY 2006-2008  
(105143) S-H2SO2-MTA –MY 2006-2008 spark arrester



Product code: (105142) S-H2SO2-MT – MY 2006-2008  
(105143) S-H2SO2-MTA –MY 2006-2008 spark arrester

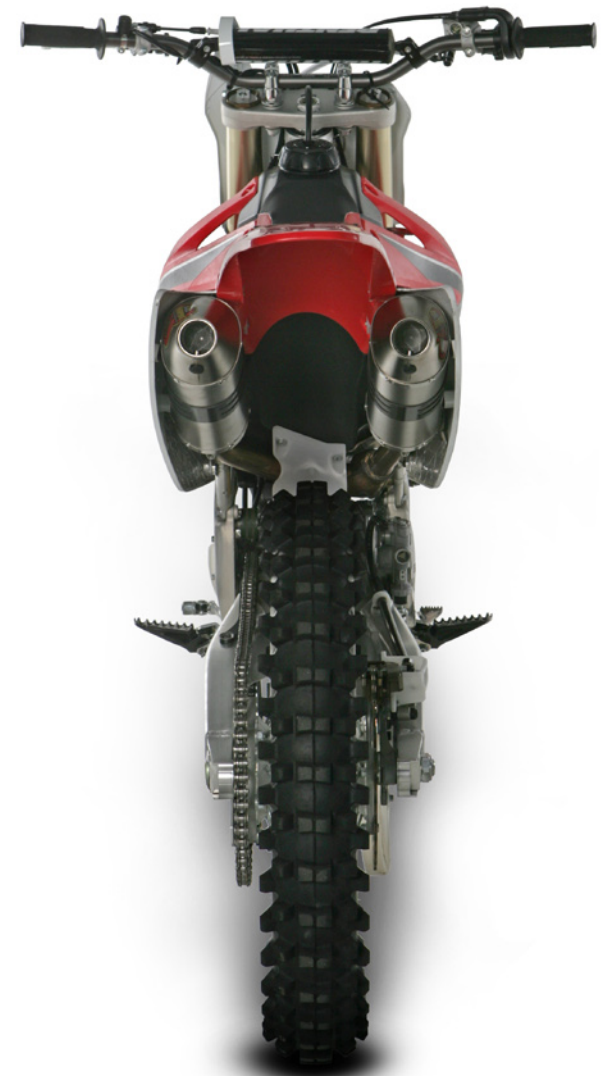

Product code: (105142) S-H2SO2-MT – MY 2006-2008  
(105143) S-H2SO2-MTA –MY 2006-2008 spark arrester

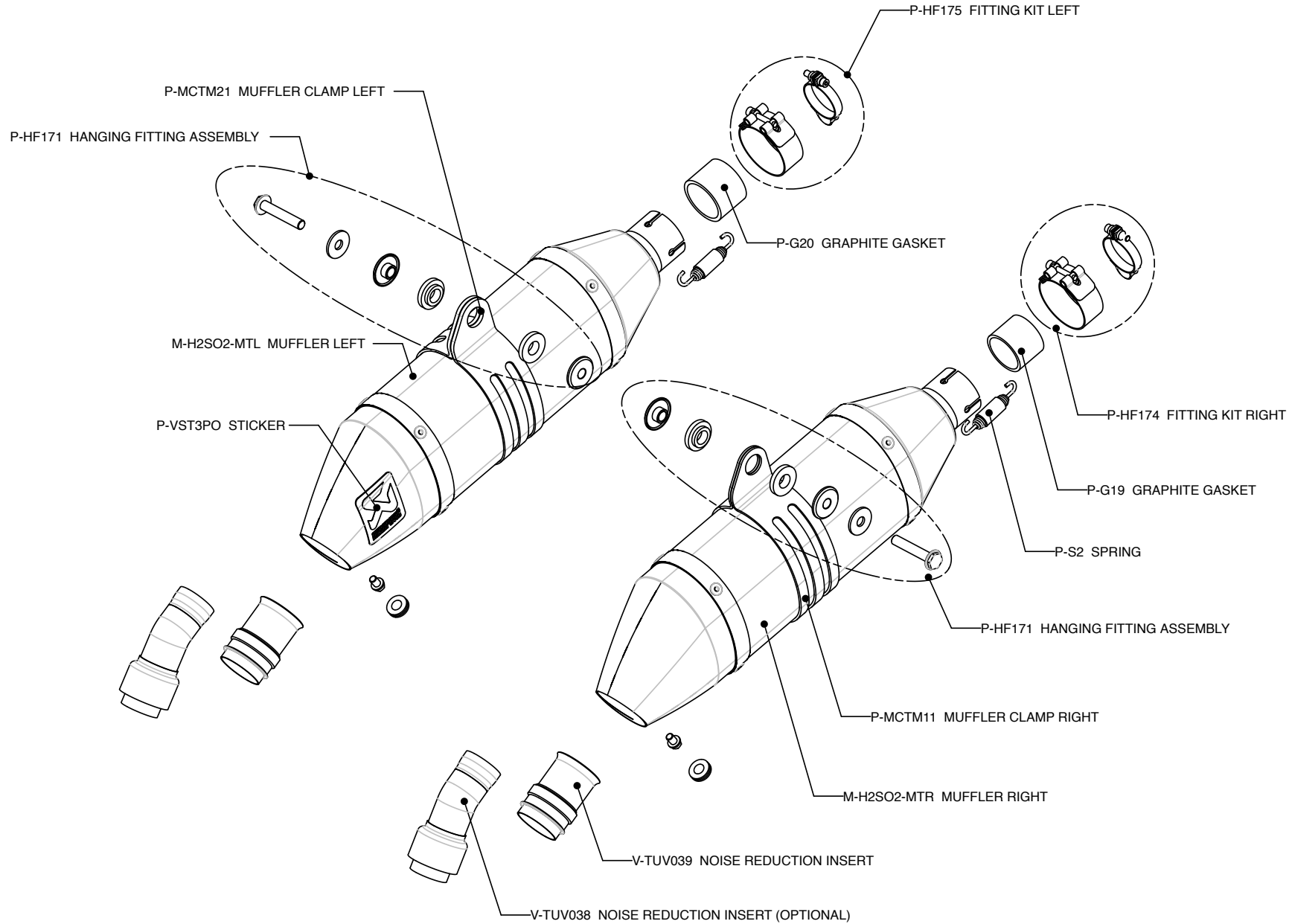

Product code: (105142) S-H2SO2-MT – MY 2006-2008  
 (105143) S-H2SO2-MTA –MY 2006-2008 spark arrester

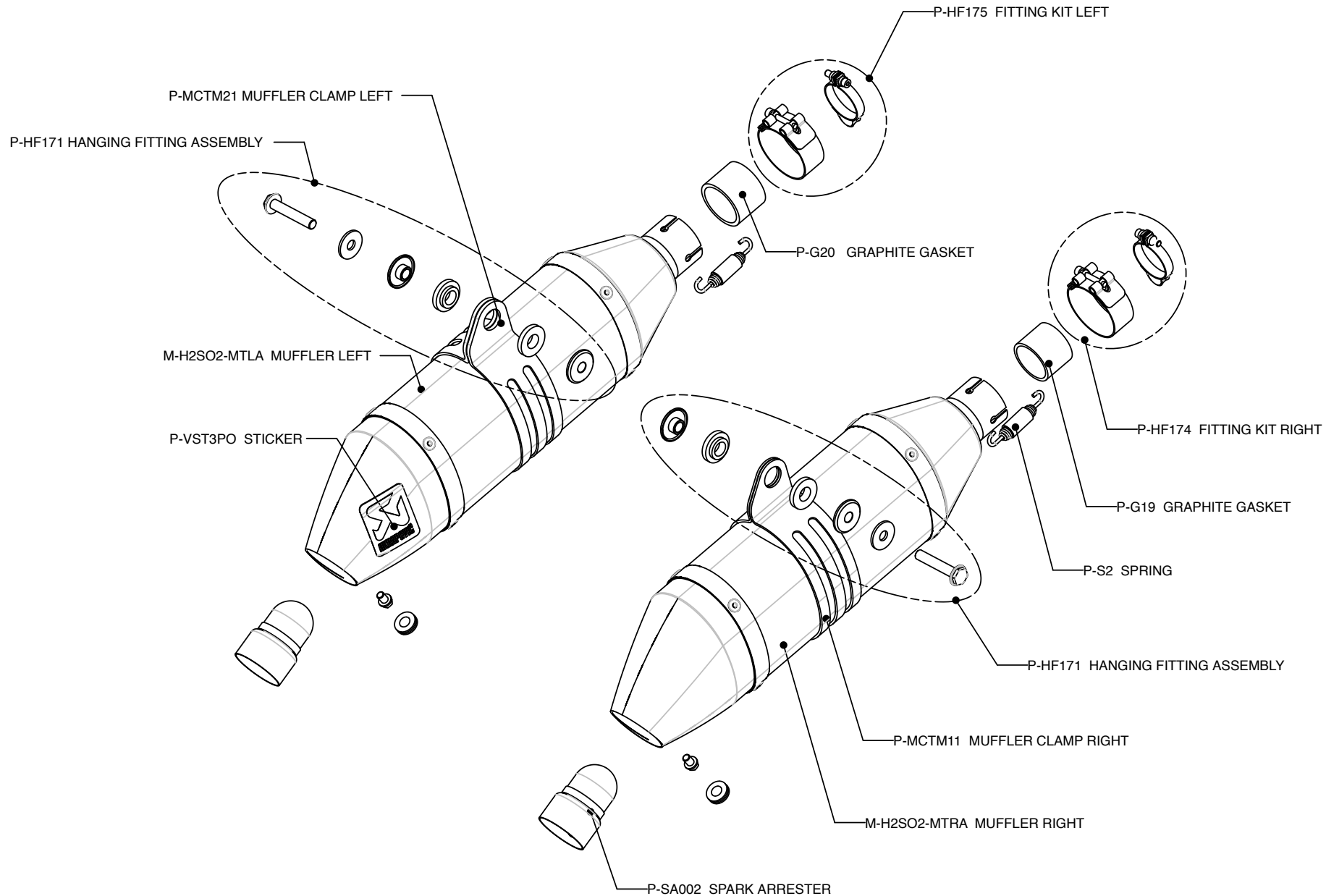

Product code: (105142) S-H2SO2-MT – MY 2006-2008  
 (105143) S-H2SO2-MTA –MY 2006-2008 spark arrester

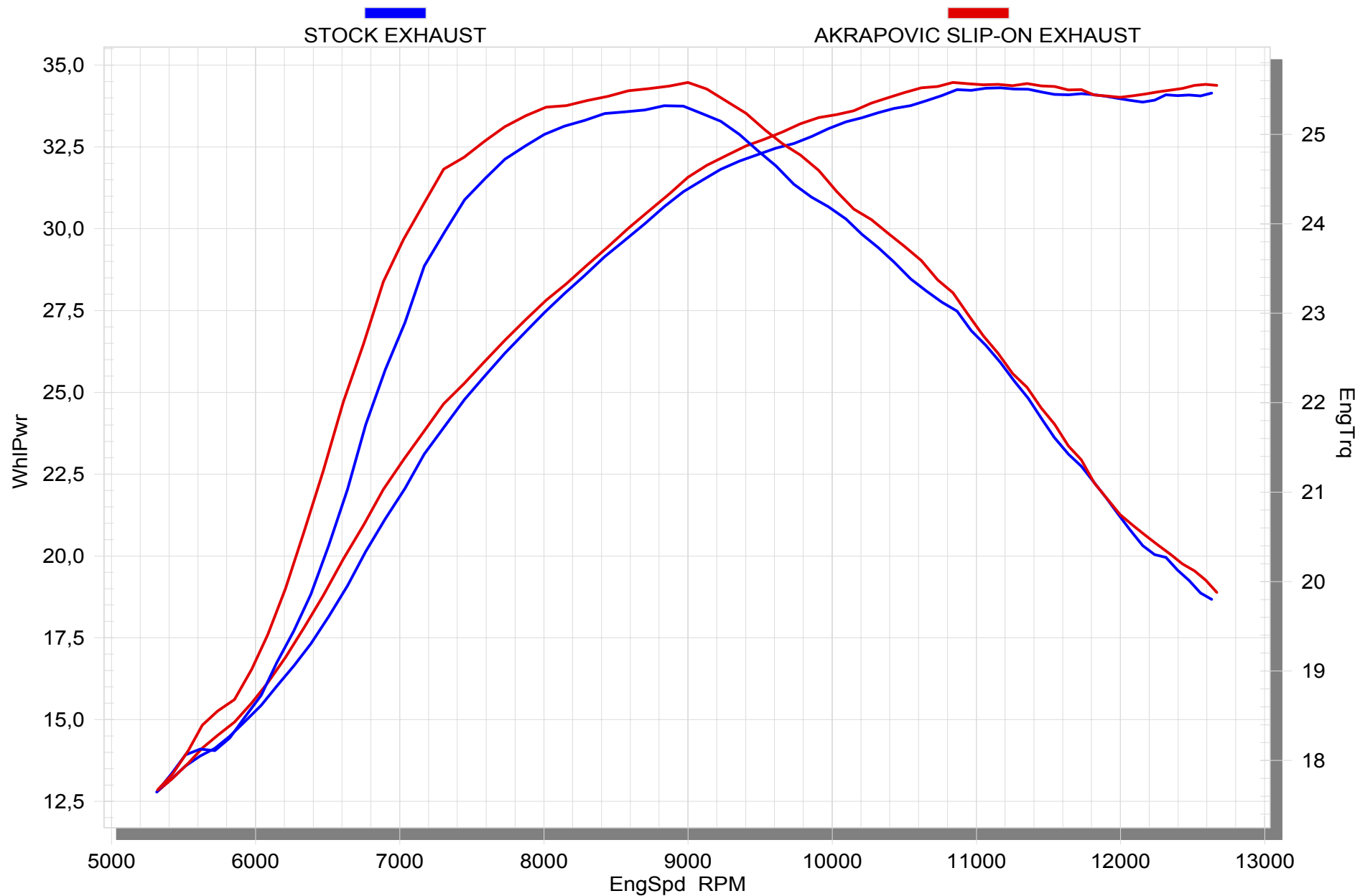

Product code: (105142) S-H2SO2-MT – MY 2006-2008  
 (105143) S-H2SO2-MTA –MY 2006-2008 spark arrester