



Honda CRF 450 R (2005)

Evolution Exhaust System

# Akrapovic Evolution Exhaust System

for the Honda CRF 450R (2005)

We have developed an Akrapovic EVOLUTION system which is similar in design to last year's model and gives the Honda CRF a major performance boost. The Akrapovic EVOLUTION system is designed to conform to the 98 dB noise limit required by the FIM for MX competition. The system is intended for professional MX riders, but due to its spectrum of effects on engine performance it is also suitable for amateur riders. 2005 stock power delivery is slightly lower than the 2004 model, which is therefore reflected in the 2005 Akrapovic power delivery figures.

## PERFORMANCE

### Measurements of the Akrapovic EVOLUTION system on the HONDA CRF 450 R:

**Power:** The linear power curve shows the quality of the design of the EVOLUTION system. The curve has no drop-outs. At 7200 rpm it joins the stock curve, and from there on the increase appears again, continuing all the way into the overrev range. At 8360 rpm the engine puts out 49.6 HP, with max. increased power of 2.1 HP in the overrev range at 9800 rpm.

**Torque:** torque is also increased throughout the entire range. The torque band is wider, giving a larger amount of torque which experienced riders will know how to make the most of.

## CONFIGURATION

The EVOLUTION system is made of top-quality materials. The conical header tube and link pipe are both made of titanium. The Akrapovic Offroad muffler is also made entirely of titanium. The link pipe – header tube connection is a free-floating joint secured with a silicon-shielded tensioning spring. At the other end, the link pipe is welded to the muffler. The muffler is attached to the frame with an Akrapovic Offroad carbon-fiber clamp.

	PERFORMANCE		
	stock	AKRAPOVIC	max. increased power
max. rear wheel power HP / rpm (measured on SuperFlow Cycle Dyn)	48.7 / 8550	49.6 / 8360	2.1 / 9800

	CONFIGURATION		
	header tubes	collector	link pipe
material	TITANIUM	-	TITANIUM
tube shape	CONICAL	-	CONICAL

interference crossover tubes	-	lambda sensor	-
header tube inner sleeves	S.S. CNC MACHNED	header tube flanges	S.S. LASER CUT
header tubes - collector connection	-	collector / header tube - link pipe connection	FREE FLOATING + SILICON SHILDED SPRING
link pipe - muffler connection	WELDED	muffler inlet cap /outlet cap	TITANIUM / TITANIUM
muffler metal interior	TITANIUM	muffler outer sleeve	TITANIUM
muffler clamp	1x CARBON-FIBER OFF ROAD	muffler bracket	-
noise damper	-	heat shield	CARBON-FIBER

OPTIONS			
link pipe	noise damper	muffler bracket	heat shield
-	-	-	-

	ADDITIONAL DATA				
	stock	AKRAPOVIC		difference	
		RACING	EVOLUTION	stock - RACING	stock - EVOLUTION
weight comparison (kg)	3.22	-	2.15	-	1.03
noise measurements (dB / rpm)	stock		AKRAPOVIC		
	98 / 4500		98 / 4500		
possibility of periodic service without removing A.E.S.	oil		oil filter		
	YES		YES		
legal for street use	NO				

Technical specifications of Akrapovic exhaust systems and related products subject to change without notice.

# Akrapovic Evolution Exhaust System for the Honda CRF 450R (2005)

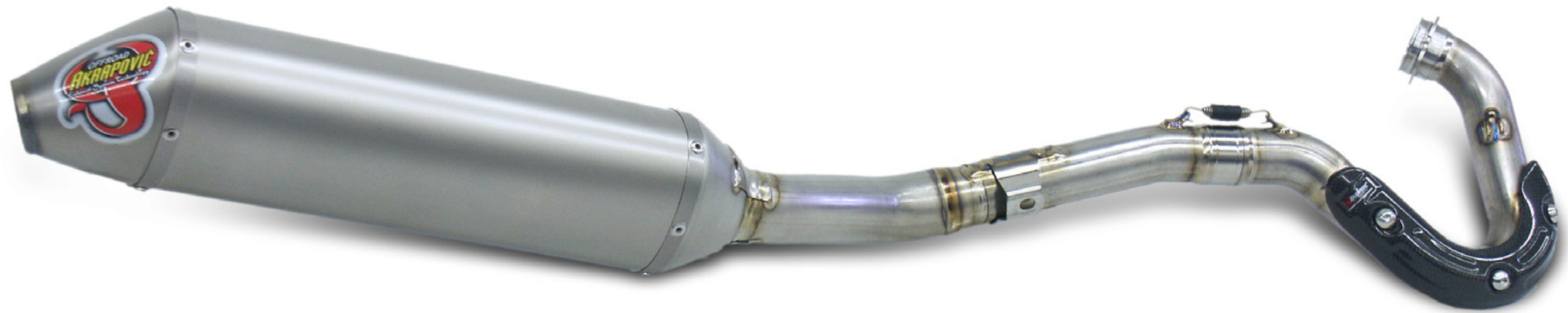

ANTI-SEIZING GREASE

CARBON-FIBER  
MUFFLER CLAMP



Off-Road  
Program

Product code: 103510 (S-H4MET5-MTT)



Akrapovic Exhaust System Technology copyright 2004, all rights reserved

# Akrapovic Evolution Exhaust System for the Honda CRF 450R (2005)



Akrapovic Exhaust System Technology copyright 2004, all rights reserved

Off-Road  
Program

# Akrapovic Evolution Exhaust System for the Honda CRF 450R (2005)



Akrapovic Exhaust System Technology, copyright 2004, all rights reserved

Off-Road  
Program

# Akrapovic Evolution Exhaust System for the Honda CRF 450R (2005)

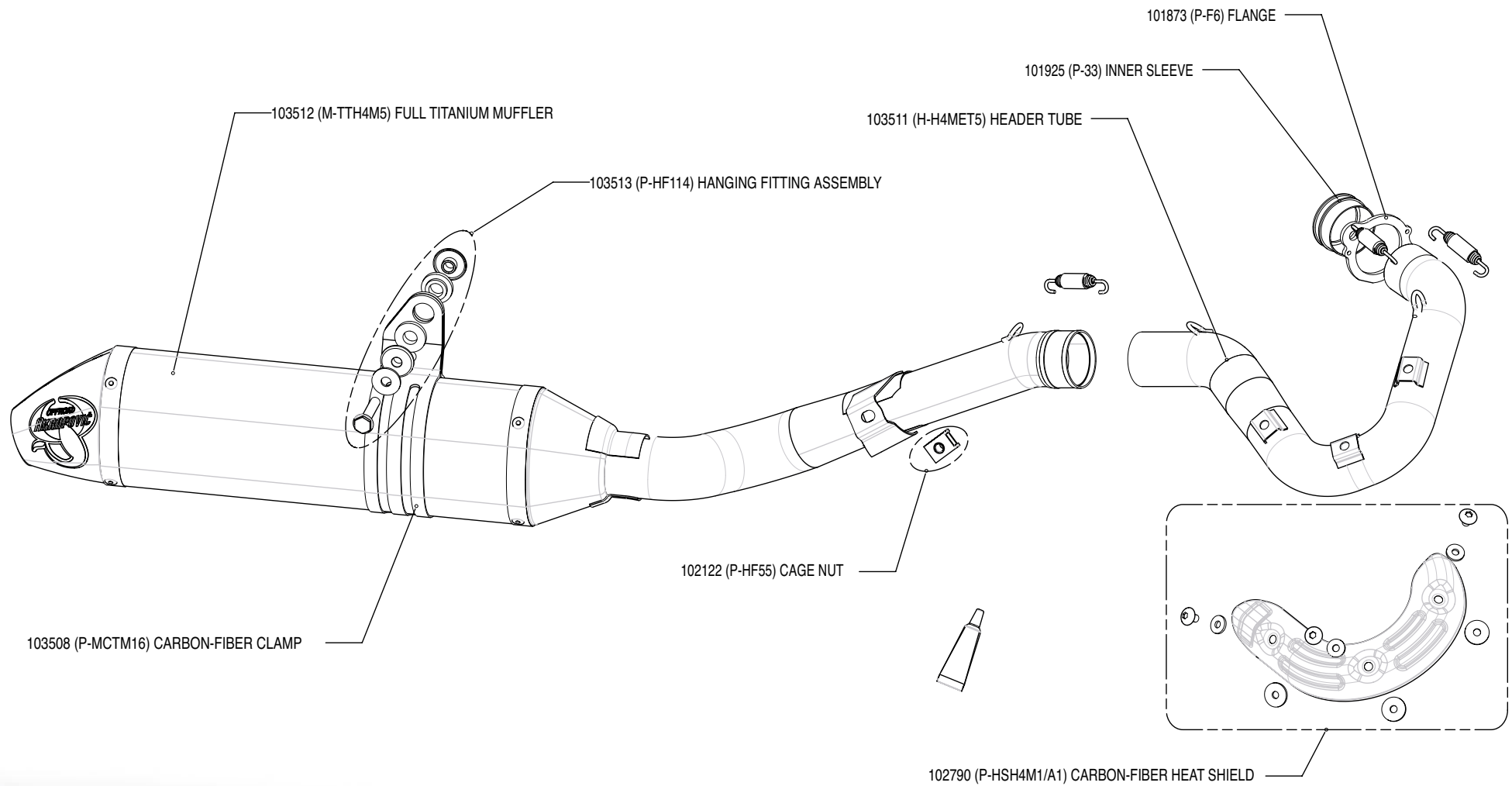

Akrapovic Exhaust System Technology copyright 2004, all rights reserved

Off-Road  
Program

# Akrapovic Evolution Exhaust System for the Honda CRF 450R (2005)

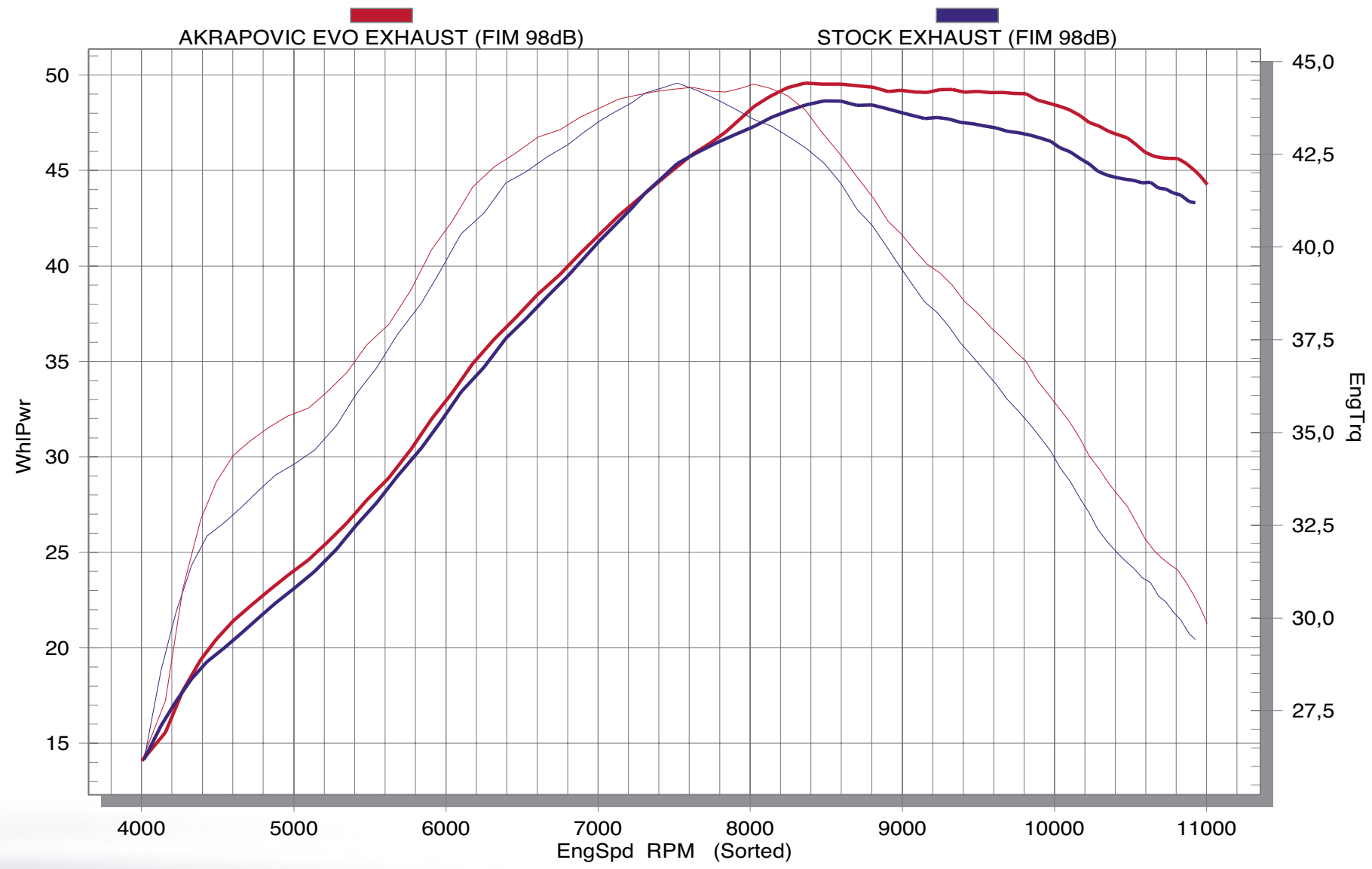

Off-Road Program



Akrapovic Exhaust System Technology copyright 2004, all rights reserved