



Kawasaki KX 250 F (2006 - 2007)

Slip-On Exhaust System

Akrapovic Slip-On Exhaust System

for the Kawasaki KX 250 F (2006 - 2007)

Akrapovic Slip-On was developed with the intention to improve the responsiveness of the engine or its performance value in accordance with the requirements of a recreational driver. It represents an advantageous compromise between performance, quality of execution, visual image and cost. It is designed for two markets: for the European and other markets it comes with a built-in noise damper, and for the American market it comes with an approved spark arrester.

PERFORMANCE

Measurements of the Akrapovic SLIP-ON system on the KAWASAKI KX 250 F (with muffler insert):

Power & Torque: the engine reacts to the change of the exhaust system by increasing the value of power and torque, which is particularly noticeable during the middle and upper range of engine rpm. The increase is suitable for recreational use of the motorcycle; for anyone wanting more, we also offer the Racing and Evolution systems.

CONFIGURATION

The Akrapovic Slip-On system is composed of a flared stainless steel link pipe which is welded to the muffler. It is attached to the stock header assembly with a sleeve joint secured with a metal clamp. The inlet cap and inner perforation are made of stainless steel, and the outlet cap is titanium. The muffler is attached to the motorcycle with Akrapovic off-road carbon-fibre clamp. The system comes with a built-in noise damper for the European and other markets, and an approved spark arrester for the American market, which is marked with a laser engraving.

	PERFORMANCE		
	stock	AKRAPOVIC	max. increased power
max. rear wheel power HP / rpm (measured on Dynojet ATV)	34.9 / 11000	35.1 / 11700	0.7 / 12000

	CONFIGURATION			
	header tubes	collector	link pipe	
material	-	-	STAINLESS STEEL	
tube shape	-	-	FLARED	
interference crossover tubes	NO	lambda sensor	NO	
header tube inner sleeves	-	header tube flanges	-	
header tubes - collector connection	-	collector / header tube - link pipe connection	GRAPHIT GASKET + METAL CLAMP	
link pipe - muffler connection	WELDED	muffler inlet cap / outlet cap	STAINLESS STEEL / STAINLESS STEEL	
muffler metal interior	STAINLESS STEEL	muffler outer sleeve	TITANIUM	
muffler clamp	CARBON-FIBER OFF ROAD	muffler bracket	-	
muffler insert	EU	NOISE DAMPER	heat shield	-
	US	SPARK ARRESTER	catalytic converter	NO

	ADDITIONAL DATA				
	stock	AKRAPOVIC		difference	
weight comparison (kg)	2.68	S.S. link pipe	Ti. link pipe	stock - S.S. link pipe	stock - Ti. link pipe
		2.13	-	0.55	-
noise measurements (dB / rpm)	stock		AKRAPOVIC		
	96 / 5000		96 / 5000		
possibility of periodic service without removing A.E.S.	oil		oil filter		
	YES		YES		
legal for street use	NO				

Technical specifications of Akrapovic exhaust systems and related products subject to change without notice.

Product code: 107090 (S-K2SO3-MT)
107092 (S-K2SO3-MTA) US market

Akrapovic Slip-On Exhaust System for the Kawasaki KX 250 F (2006 - 2007)



CARBON-FIBER
MUFFLER CLAMP

Product code: 107090 (S-K2SO3-MT)
107092 (S-K2SO3-MTA) US market

Akrapovic Slip-On Exhaust System for the Kawasaki KX 250 F (2006 - 2007)



Akrapovic Exhaust System Technology copyright 2005, all rights reserved

Off-Road
Program

Product code: 107090 (S-K2SO3-MT)
107092 (S-K2SO3-MTA) US market

Akrapovic Slip-On Exhaust System for the Kawasaki KX 250 F (2006 - 2007)



Akrapovic Exhaust System Technology copyright 2005, all rights reserved

Off-Road
Program

Product code: 107090 (S-K2SO3-MT)
107092 (S-K2SO3-MTA) US market

Akrapovic Slip-On Exhaust System for the Kawasaki KX 250 F (2006 - 2007)

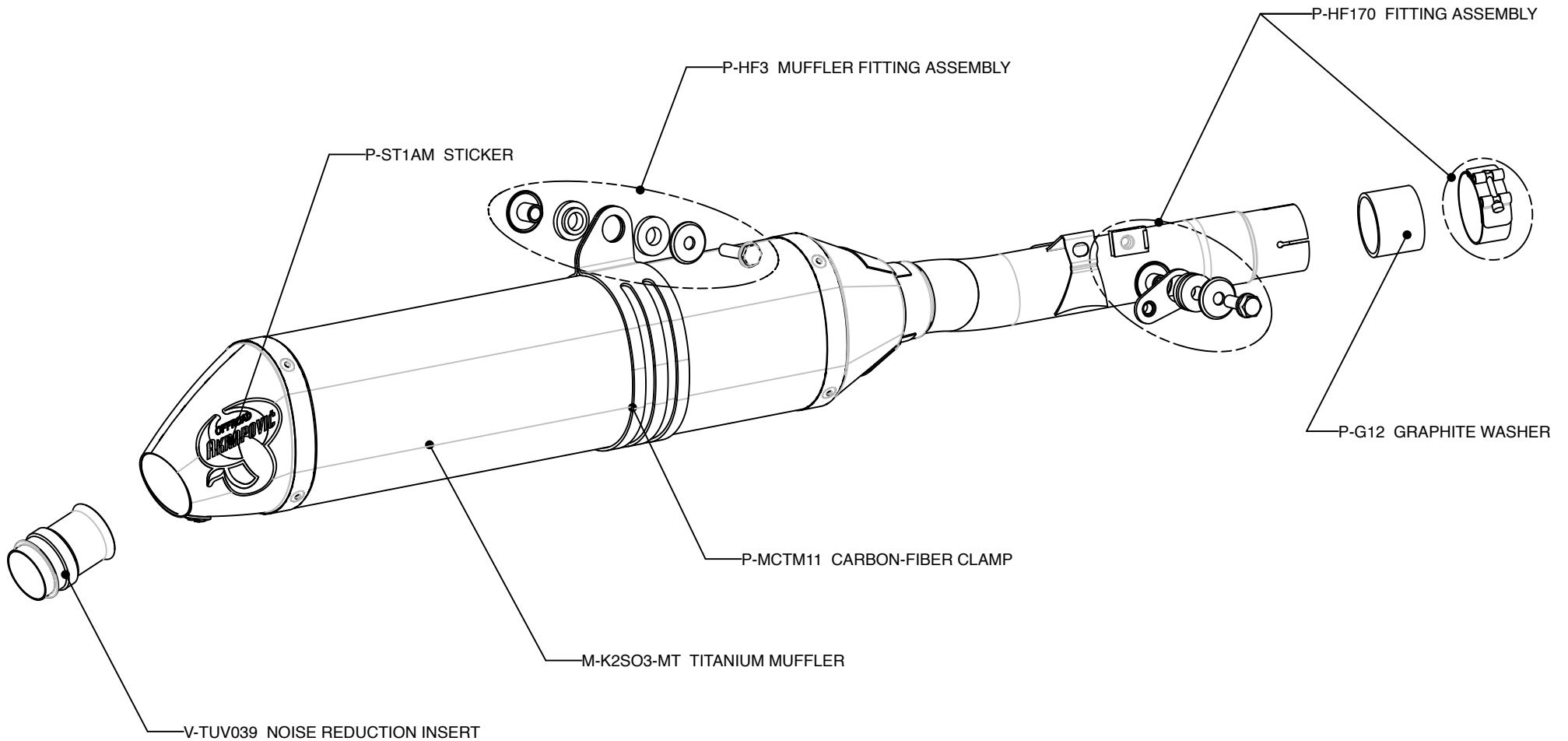

Off-Road
Program

Product code: 107090 (S-K2SO3-MT)

Akrapovic Slip-On Exhaust System for the Kawasaki KX 250 F (2006 - 2007)

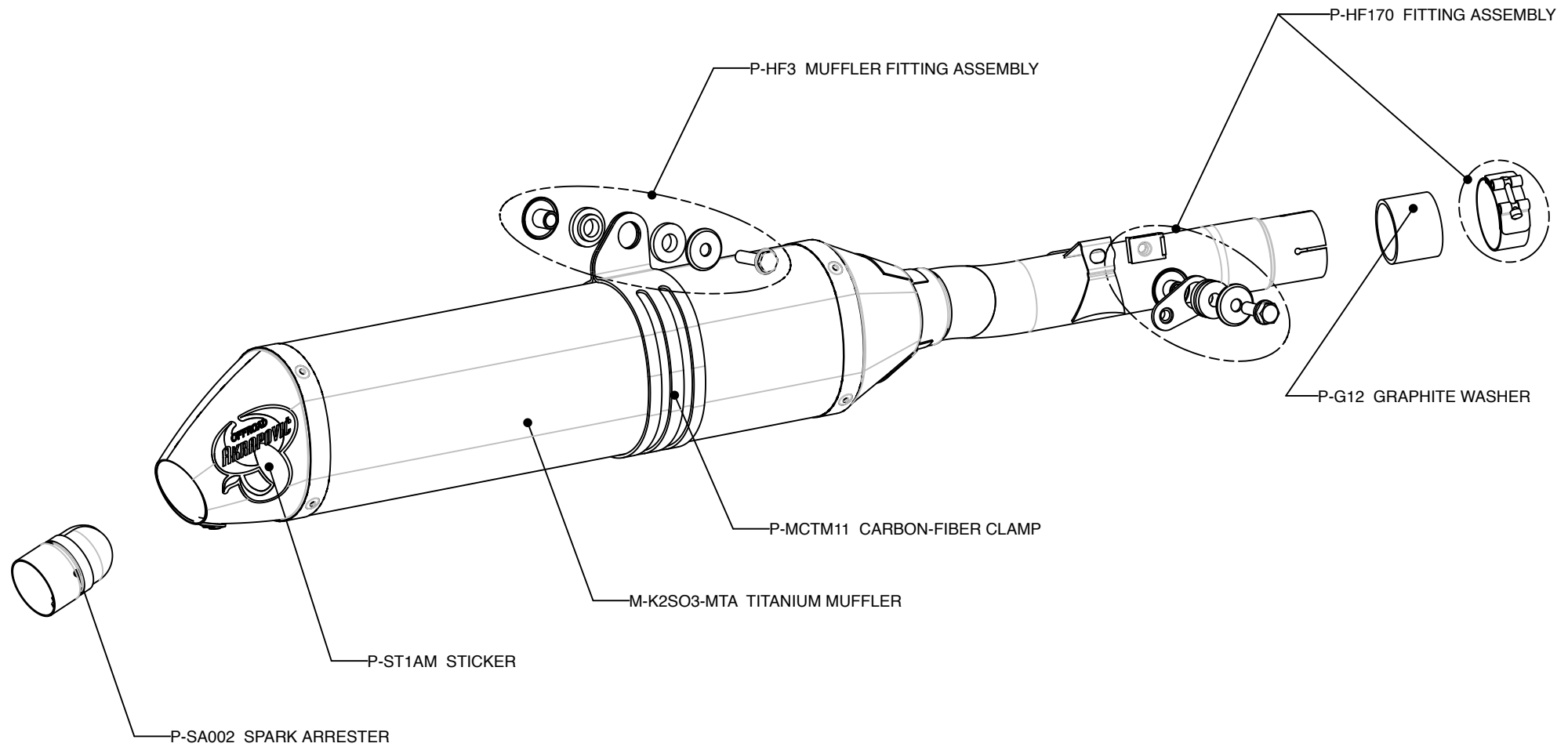

Off-Road
Program

Product code: 107092 (S-K2SO3-MTA) US market

Akrapovic Slip-On Exhaust System

for the Kawasaki KX 250 F (2006 - 2007)

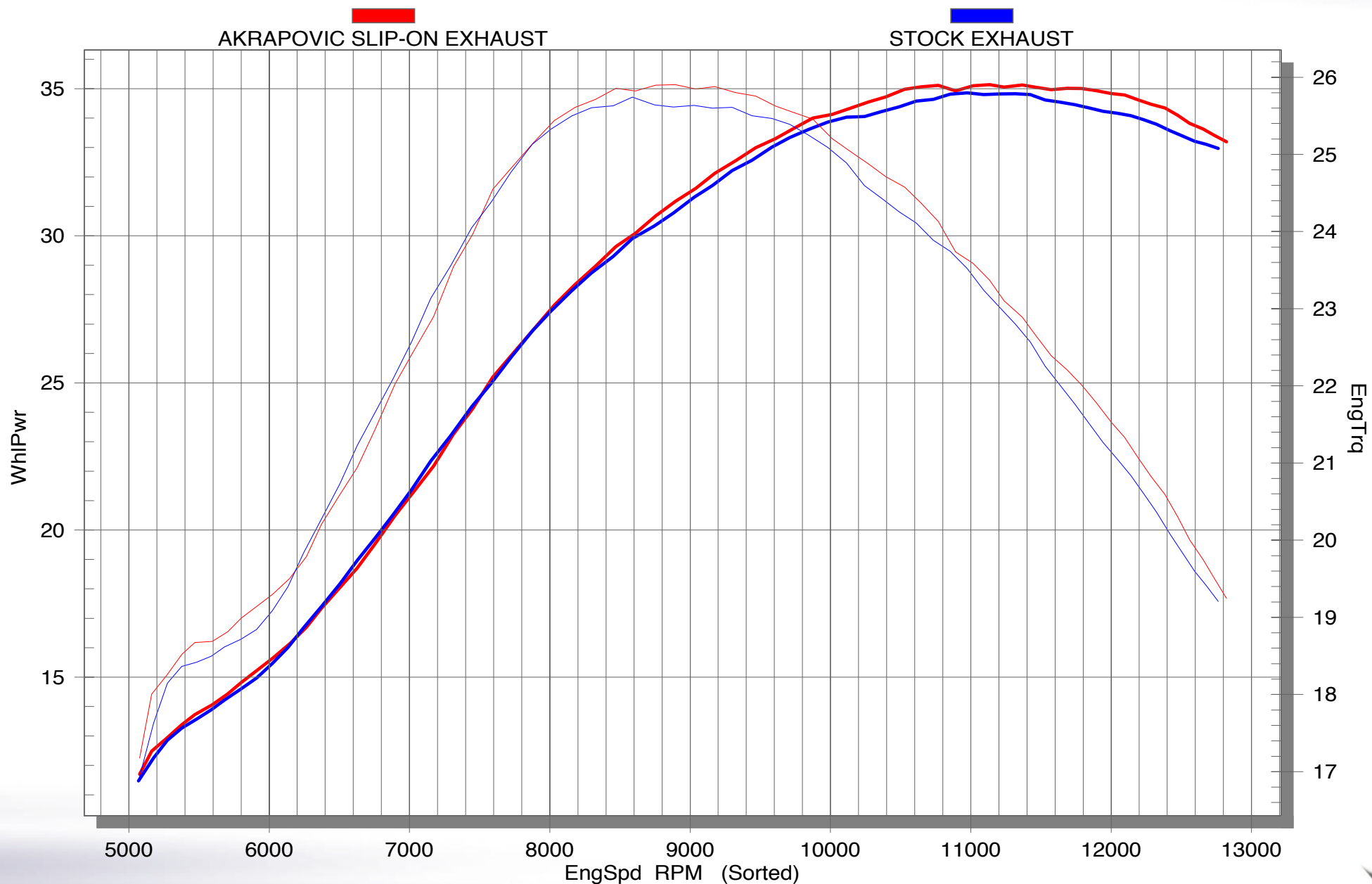

Akrapovic Exhaust System Technology copyright 2005, all rights reserved

Off-Road Program

Product code: 107090 (S-K2SO3-MT)
107092 (S-K2SO3-MTA) US market

