



KAWASAKI KX 450 F

(2008)

SLIP-ON EXHAUST SYSTEM

www.akrapovic.net

The Akrapovic Slip-On system was designed to improve engine performance in the most effective part of the rpm range and improve riding characteristics for recreational MX riders. More demanding riders should see our Akrapovic Racing and Evolution complete system. The Akrapovic Slip-On system includes a noise damper for the European market, and an approved spark arrester for the US market.

PERFORMANCE

Measurements of the Akrapovic SLIP-ON system on the KAWASAKI KX 450 F (with muffler insert):

Power & Torque: the engine reacts to the change of the exhaust system by increasing the value of power and torque, which is particularly noticeable in middle range of engine rpm. We measured max. power increase of 1.9 HP at 5600 rpm.

CONFIGURATION

The Akrapovic Slip-On system is composed of a flared stainless steel link pipe which is welded to the muffler. It is attached to the stock header assembly with a sleeve joint secured with a metal clamp. The inlet cap, outlet cap and inner perforation are made of stainless steel while outer sleeve is made of titanium. The muffler is attached to the KX-F with Akrapovic offroad carbon-fiber clamp. The system comes with a built-in noise damper for the European and other markets, and an approved spark arrester for the American market, which is marked with a laser engraving.

	PERFORMANCE		
	stock	AKRAPOVIC	max. increased power
max. rear wheel power HP / rpm <small>(measured on Dynojet ATV)</small>	48.2 / 8700	48.5 / 8300	1.9 / 5600

	CONFIGURATION		
	header tubes	collector	link pipe
material	-	-	STAINLESS STEEL / TITANIUM
tube shape	-	-	flared

interference crossover tubes	-	lambda sensor	-
header tube inner sleeves	-	header tube flanges	-
header tubes - collector connection	-	collector / header tube - link pipe connection	SLEEVE JOINT + GRAPHITE GASKET+ METAL CLAMP
link pipe - muffler connection	WELDED	muffler inlet cap /outlet cap	S.S. – S.S.
muffler metal interior	STAINLESS STEEL	muffler outer sleeve	TITANIUM
muffler clamp	CARBON-FIBER	muffler bracket	-
muffler insert	EU	NOISE DAMPER	heat shield
	US	SPARK ARRESTER	catalytic converter

	ADDITIONAL DATA				
	stock	AKRAPOVIC		difference	
		S.S. link pipe	TITANIUM link pipe	stock - S.S.	stock - titanium
weight comparison (kg)	3.02	2.19	-	0.83	-
noise measurements (dB / rpm)	stock		AKRAPOVIC		
	94 / 4500		94 / 4500		
possibility of periodic service without removing A.E.S.	oil		oil filter		
	YES		YES		
legal for street use	NO				

Technical specifications of Akrapovic exhaust systems and related products subject to change without notice.



Product code: (107082) S-K4SO2-MT
(107084) S-K4SO2-MTA spark arrester



Product code: (107082) S-K4SO2-MT
(107084) S-K4SO2-MTA spark arrester



Product code: (107082) S-K4SO2-MT
(107084) S-K4SO2-MTA spark arrester

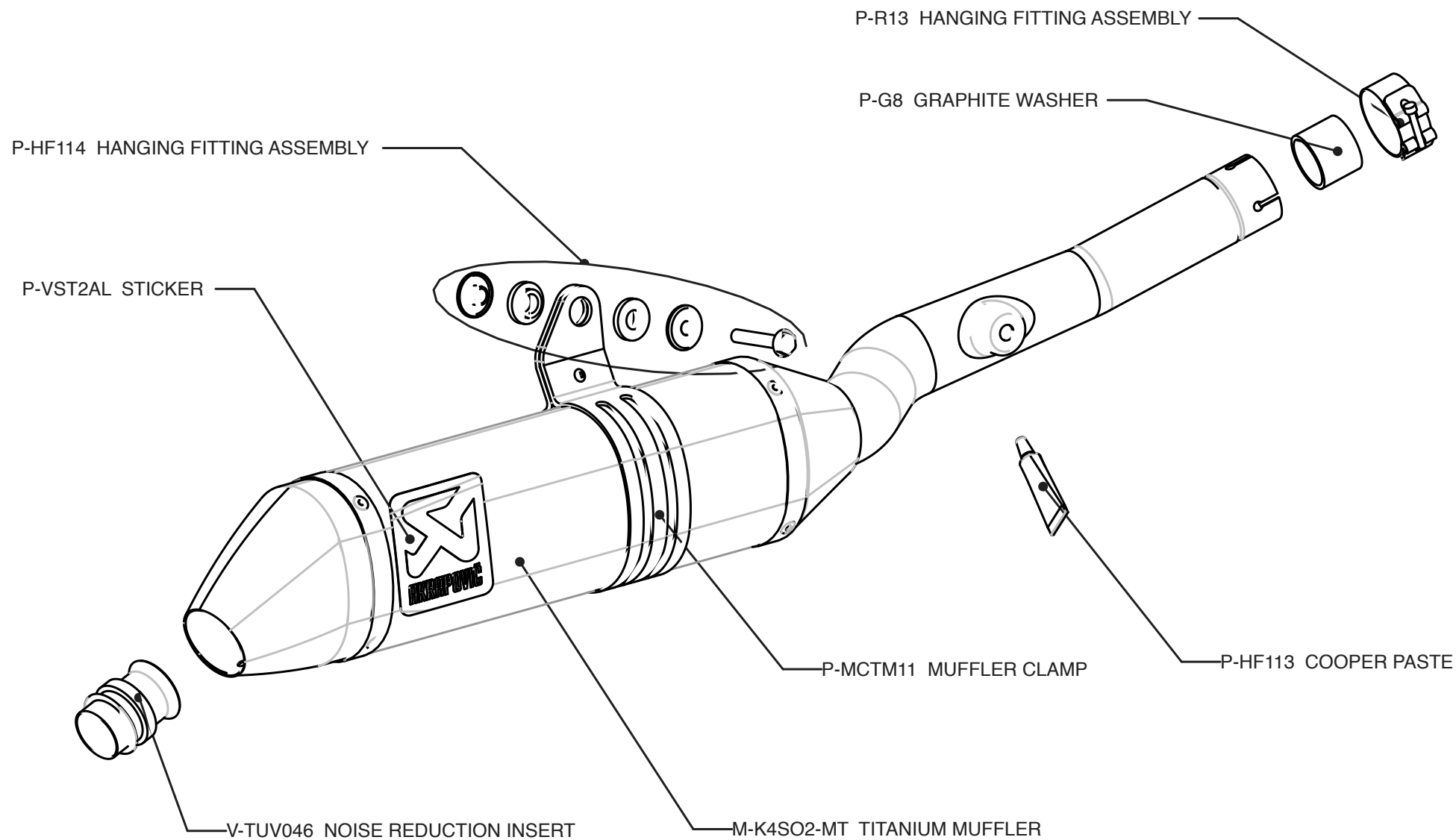

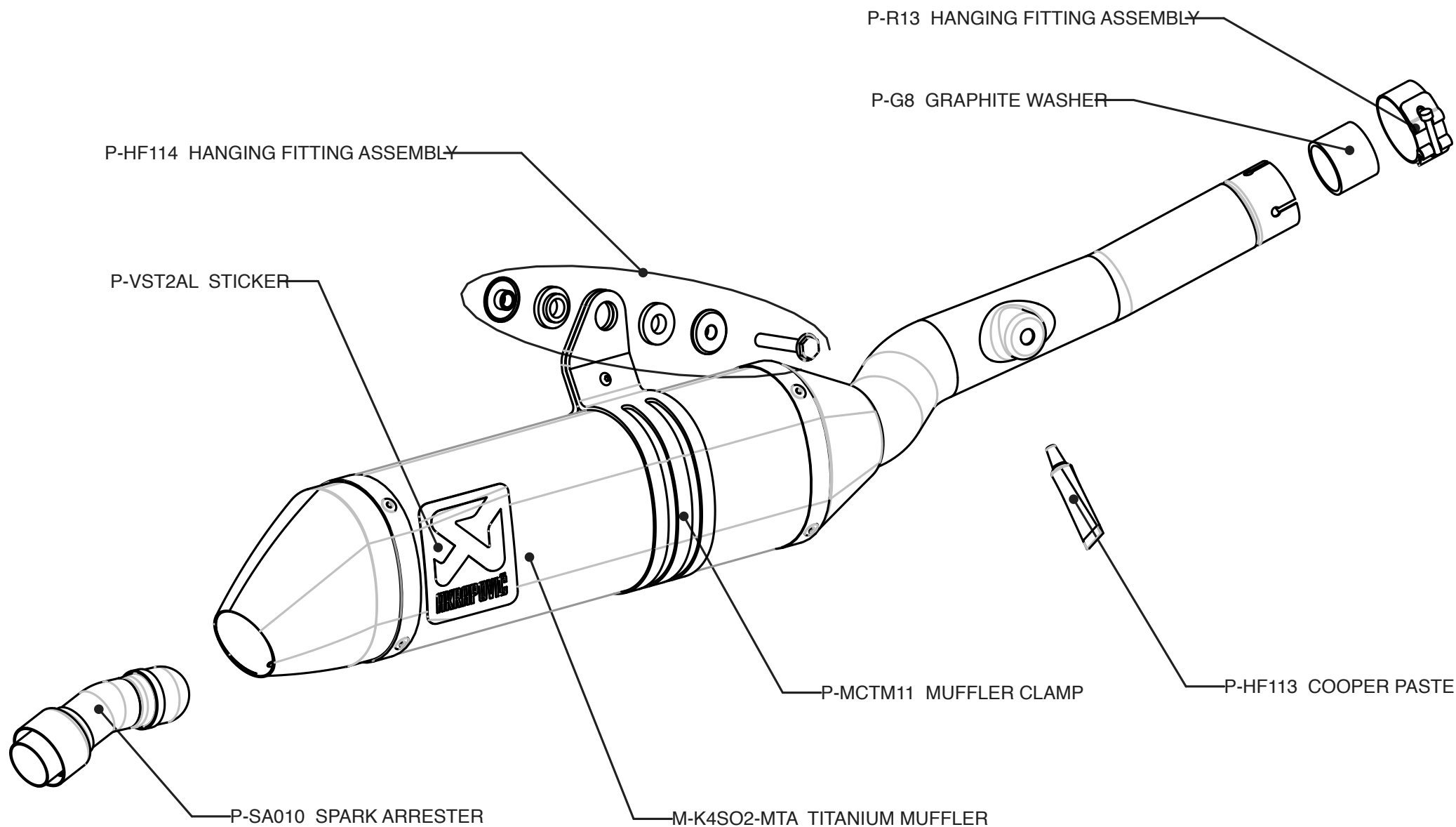

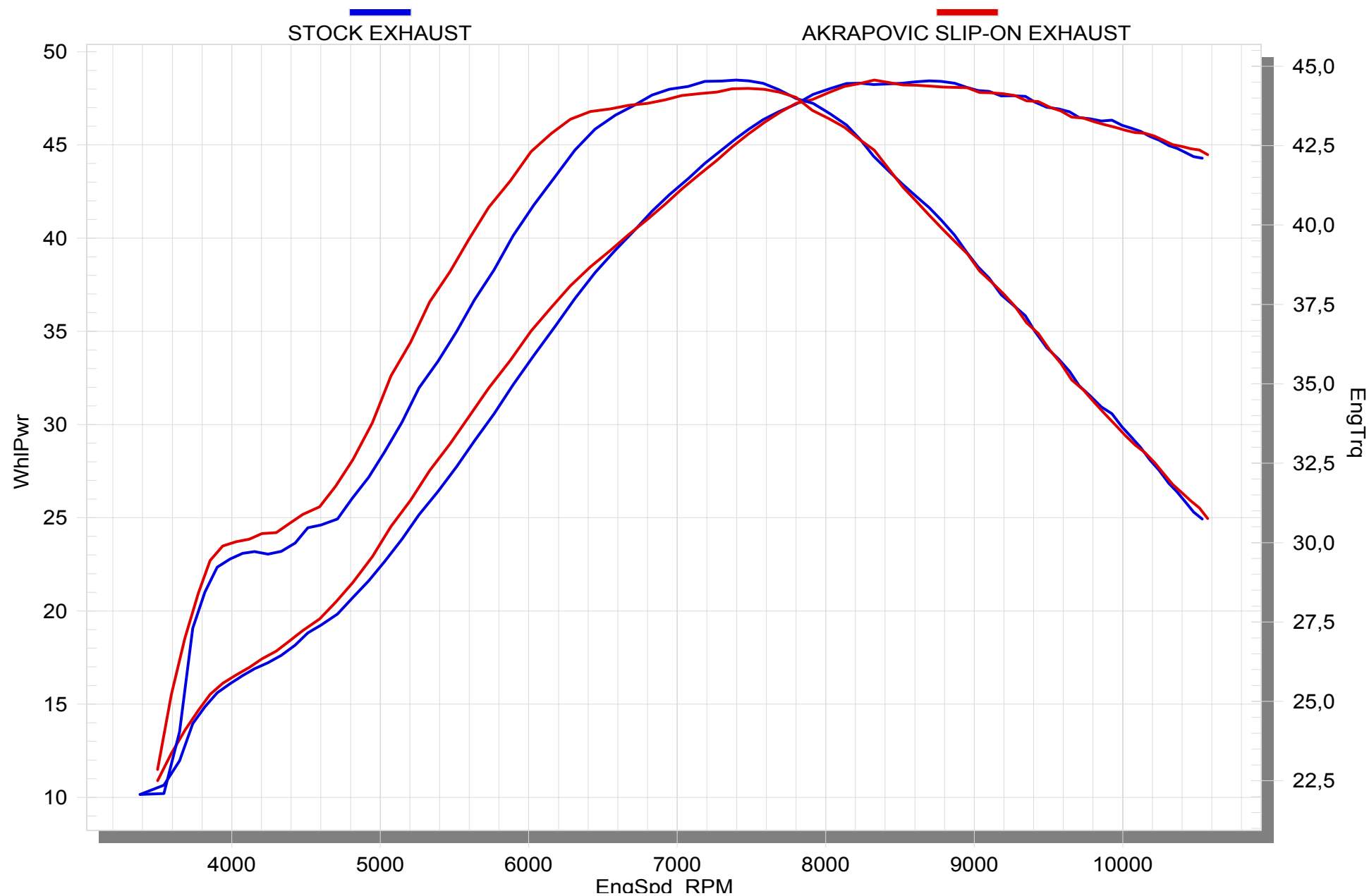

Product code: (107082) S-K4SO2-MT
 (107084) S-K4SO2-MTA spark arrester

