



Kawasaki Z 1000 (2007)

Racing/Evolution Exhaust System

Akrapovic Racing/Evolution Exhaust System

for the Kawasaki Z 1000 (2007)

The Akrapovic RACING OPEN & EVOLUTION OPEN line is the highest level of Akrapovic exhaust systems and with hexagonal shaped muffler fits perfectly with the aggressive character of the 'Z'. The conical tubing with interference crossover tubes between the header tubes work exceptionally well. With the Akrapovic exhaust system you will get massive power boost, more torque, a sportier sound and an even more aggressive top-level look on this muscular roadster. You can choose between classy titanium or carbon-fiber mufflers that stand out through their excellent quality. The systems are available in open version only. Besides great power and torque, you will also save in overall weight, as the Akrapovic system weighs 10.21 kg (RACING) or 11.5 kg (EVOLUTION) less than the stock assembly.

PERFORMANCE

Measurements of the Akrapovic RACING OPEN & EVOLUTION OPEN system on the Kawasaki Z 1000:

The power curve shows a huge increase over the stock performance figures. It is much more linear, which means the engine is pulling strong and consistently right from the lowest rpm to the highest part of the overrev range. We measured a maximum increased power of 10.0 HP at 10270 rpm.

The same goes for torque, which is also increased through entire rpm range. The drop-outs in the stock curve are filled and like the power curve, there is a major increase from 4000 rpm on.

CONFIGURATION

The configuration of the Akrapovic RACING OPEN & EVOLUTION OPEN system for the Z 1000 is 4-2-1, made of conical stainless steel or titanium tubes. The system includes interference crossover tubes between the header tubes, giving the Kawasaki increased performance characteristics. The muffler is available with either a titanium or carbon-fiber outer sleeve, attached to the motorcycle with an Akrapovic carbon-fiber muffler clamp. The individual elements of the system - header tubes, collector, link pipe and muffler - are connected with sleeve joints, secured with silicon-shielded springs.

	PERFORMANCE		
	stock	AKRAPOVIC	max. increased power
max. rear wheel power HP / rpm <small>(measured on SuperFlow Cycle Dyn)</small>	116.2 / 9835	124.3 / 10030	10 / 10270

	CONFIGURATION		
	header tubes	collector	link pipe
material	S.S. / Ti	S.S. / Ti	S.S. / Ti
tube shape	CYLINDRICAL	CONICAL	CONICAL

interference crossover tubes	YES	lambda sensor	YES	
header tube inner sleeves	S.S. CNC MACHINED	header tube flanges	ALU CNC MACHINED	
header tubes - collector connection	SLEEVE JOINT + SILICON SHIELDED SPRING	collector / header tube - link pipe connection	SLEEVE JOINT + SILICON SHILED SPRING	
link pipe - muffler connection	SLEEVE JOINT + SILICON SHIELDED SPRING	muffler inlet cap /outlet cap	Ti / Carb.-fiber	
muffler metal interior	Ti	muffler outer sleeve	Ti / Carb.-fiber	
muffler clamp	CARBON-FIBER	muffler bracket	NO	
muffler insert	EU	YES(track legal)	heat shield	NO
	US	-	catalytic converter	NO

	ADDITIONAL DATA				
	stock	AKRAPOVIC		difference	
		RACING	EVOLUTION	stock - RACING	stock - EVOLUTION
weight comparison (kg)	15.6	5.39	4.1	10.21	11.5
noise measurements (dB / rpm)	stock		AKRAPOVIC		
	91 / 5000		97.1 / 5000		
possibility of periodic service without removing A.E.S.	oil		oil filter		
	YES		YES		
legal for street use	NO				

Technical specifications of Akrapovic exhaust systems and related products subject to change without notice.

Product code: 108012 (S-K10R4-RC), 108011 (S-K10R4-RT) racing
107947 (S-K10RFT4T-RC), 107946 (S-K10RFT4T-RT) evolution

Akrapovic Racing/Evolution Exhaust System for the Kawasaki Z 1000 (2007)



CARBON-FIBER
MUFFLER CLAMP

Product code: 108012 (S-K10R4-RC), 108011 (S-K10R4-RT) racing
107947 (S-K10RFT4T-RC), 107946 (S-K10RFT4T-RT) evolution

Akrapovic Racing/Evolution Exhaust System for the Kawasaki Z 1000 (2007)



Akrapovic Exhaust System Technology copyright 2007, all rights reserved

Road
Program

Product code: 108012 (S-K10R4-RC), 108011 (S-K10R4-RT) racing
107947 (S-K10RFT4T-RC), 107946 (S-K10RFT4T-RT) evolution

Akrapovic Racing/Evolution Exhaust System for the Kawasaki Z 1000 (2007)



Akrapovic Exhaust System Technology copyright 2007, all rights reserved

Road Program

Product code: 108012 (S-K10R4-RC), 108011 (S-K10R4-RT) racing
107947 (S-K10RFT4T-RC), 107946 (S-K10RFT4T-RT) evolution

Akrapovic Racing/Evolution Exhaust System for the Kawasaki Z 1000 (2007)

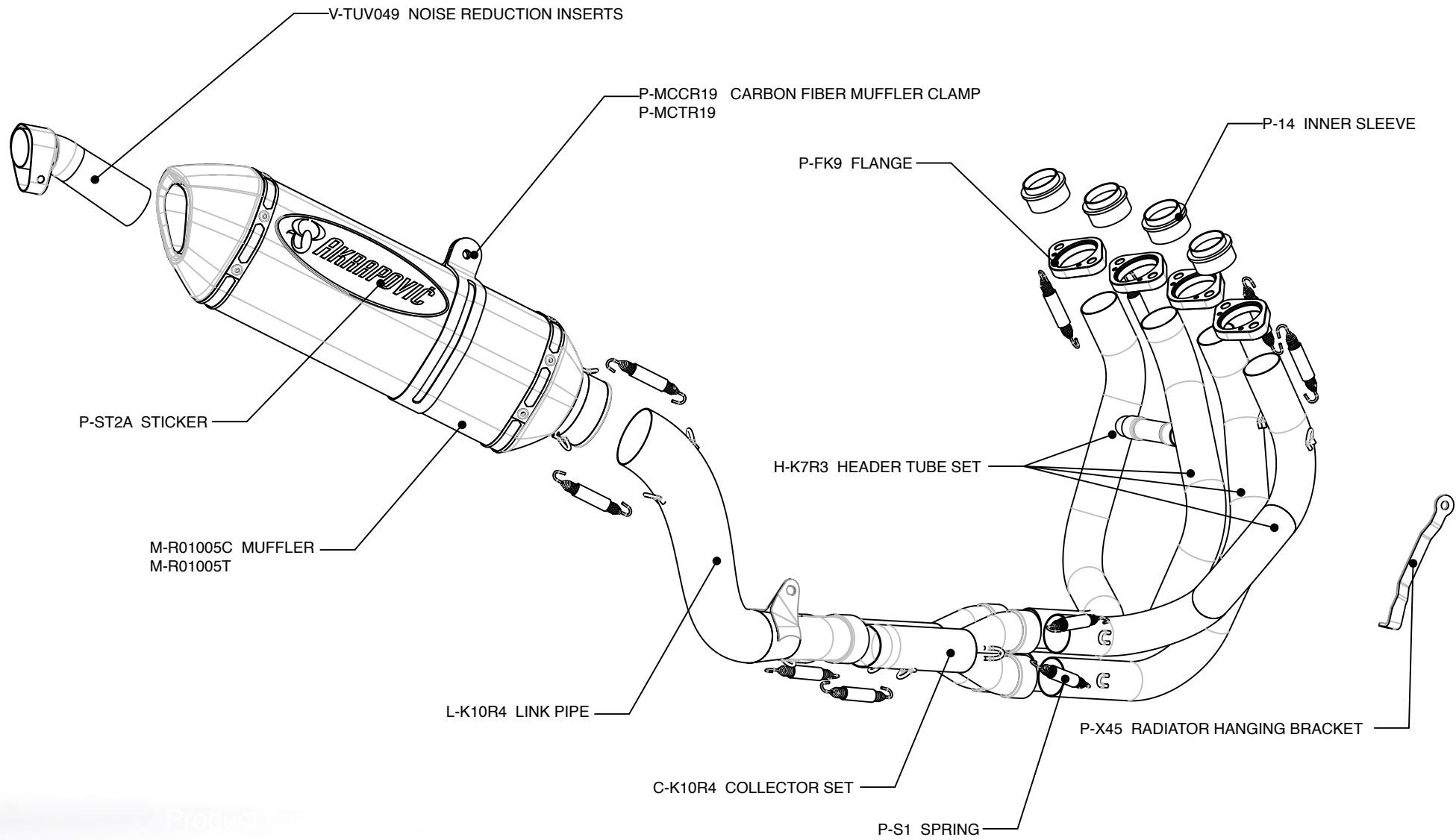

Akrapovic Exhaust System Technology copyright 2007, all rights reserved

Road
Program

Product code: 108012 (S-K10R4-RC), 108011 (S-K10R4-RT) racing
107947 (S-K10RFT4T-RC), 107946 (S-K10RFT4T-RT) evolution



Akrapovic Racing/Evolution Exhaust System for the Kawasaki Z 1000 (2007)

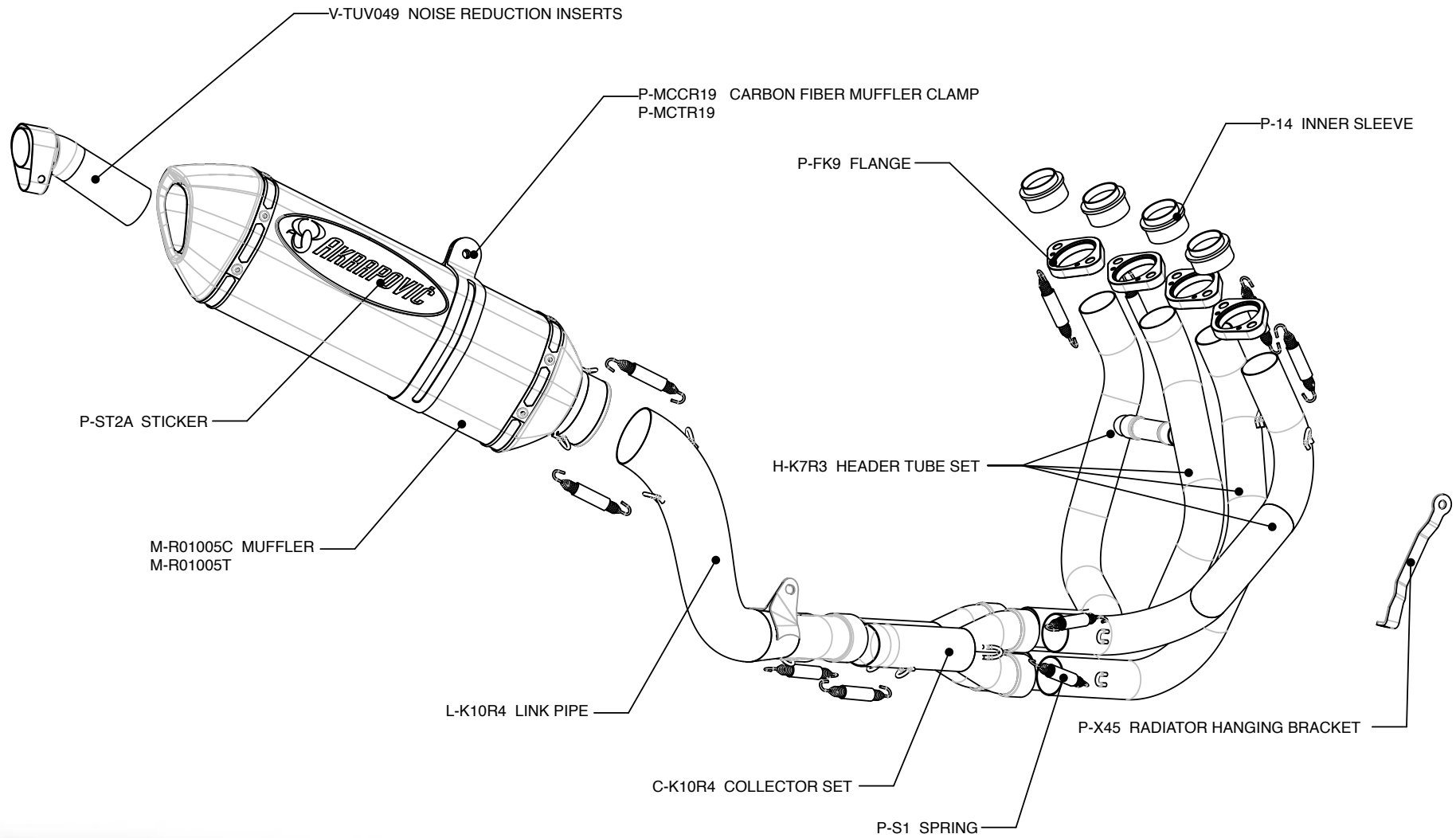

Road
Program

Product code: 108012 (S-K10R4-RC), 108011 (S-K10R4-RT) racing
107947 (S-K10RFT4T-RC), 107946 (S-K10RFT4T-RT) evolution

Akrapovic Racing/Evolution Exhaust System for the Kawasaki Z 1000 (2007)

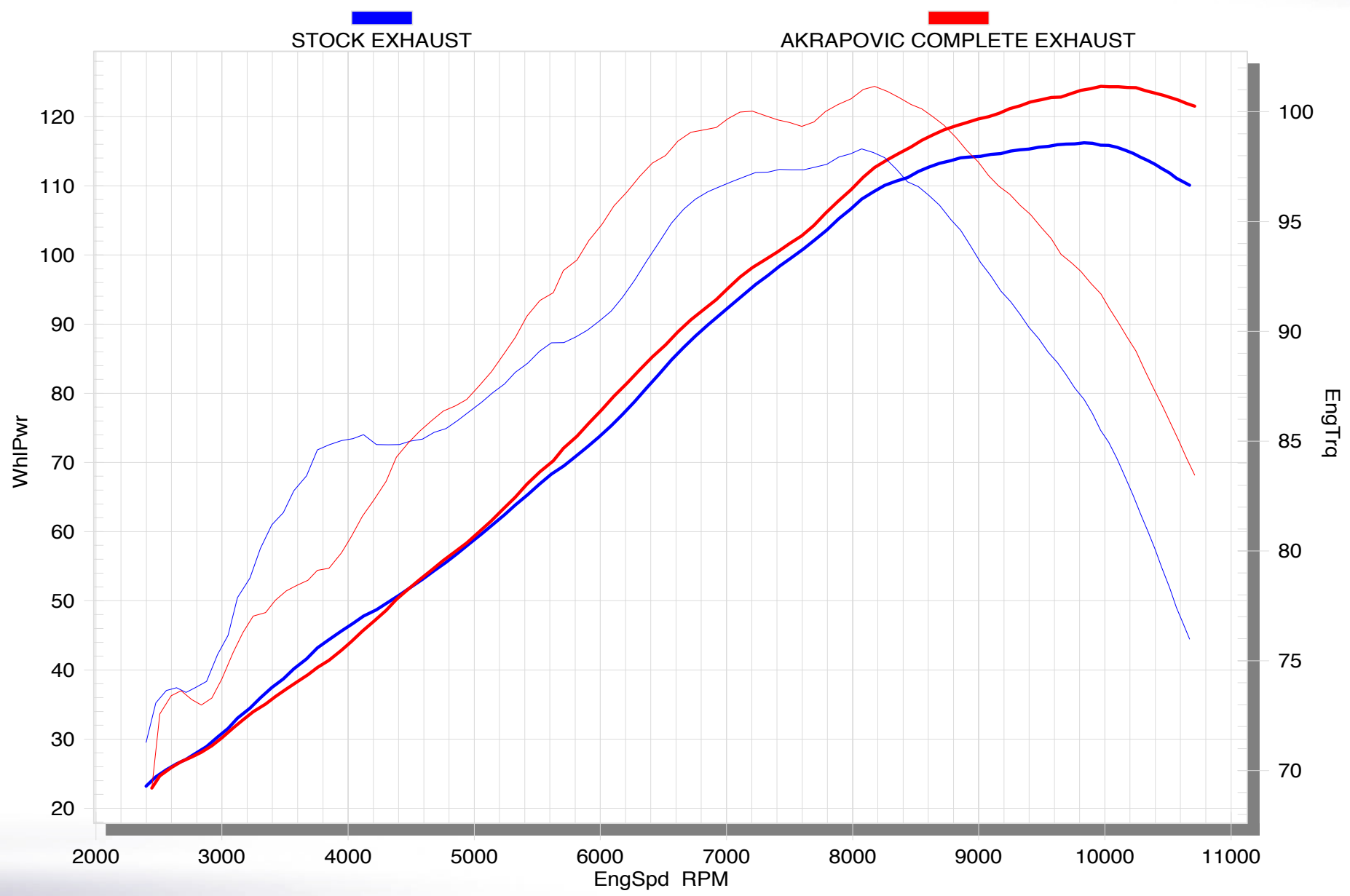

Road Program

Product code: 108012 (S-K10R4-RC), 108011 (S-K10R4-RT) racing
107947 (S-K10RFT4T-RC), 107946 (S-K10RFT4T-RT) evolution



Akrapovic Exhaust System Technology copyright 2007, all rights reserved