



KAWASAKI ZZR 1400

(2006 - 2007)

RACING & EVOLUTION EXHAUST SYSTEM

www.akrapovic.net

The Akrapovic RACING OPEN & EVOLUTION OPEN line is the highest level of exhaust systems tuning and with hexagonal shaped muffler fits perfectly to character of the superfast ZZR 1400. The conical tubing with interference crossover tubes between the header tubes work exceptionally well. With the Akrapovic exhaust system you will get massive power boost, more torque, a sportier sound and an even more aggressive top-level look on this muscular motorcycle. You can choose between classy titanium or carbon-fiber mufflers that stand out through their excellent quality. The systems are available in open version only. You will also save in overall weight, as the Akrapovic system weighs 8.63 kg (RACING) or 10.5 kg (EVOLUTION) less than the stock assembly.

PERFORMANCE

Measurements of the Akrapovic RACING OPEN & EVOLUTION OPEN system on the Kawasaki ZZR 1400 (without muffler insert):

The power curve shows a huge increase over the stock performance figures. It is much more linear, which means the engine is pulling strong and consistently right from the lowest rpm to the highest part of the overrev range. We measured a max. power output on rear wheel of 180.6 HP and maximum increased power of 12.7 HP at 10100 rpm. The same goes for torque, which is also increased through entire rpm range. The drop-outs in the stock curve are filled and like the power curve, there is a major increase from 4000 rpm on.

CONFIGURATION

The configuration of the Akrapovic RACING OPEN & EVOLUTION OPEN system for the ZZR 1400 is 4-2-1, made of conical stainless steel or titanium tubes and a muffler. The system includes interference crossover tubes between the header tubes and CNC machined header tube inner sleeves. The mufflers are available with either a titanium or carbon-fiber outer sleeve, attached to the motorcycle with an Akrapovic carbon-fiber muffler clamp. The individual elements of the system – header tubes, collector, link pipe and muffler – are connected with sleeve joints, secured with silicon-shielded springs.

Technical specifications of Akrapovic exhaust systems and related products subject to change without notice.

	PERFORMANCE		
	stock	AKRAPOVIC	max. increased power
max. rear wheel power HP / rpm <small>(measured on Dynojet ATV)</small>	171 / 9970	180.6 / 9750	12.7 / 10100

	CONFIGURATION		
	header tubes	collector	link pipe
material	STAINLESS STEEL / TITANIUM	STAINLESS STEEL / TITANIUM	STAINLESS STEEL / TITANIUM
tube shape	CYLINDRICAL	CYLINDRICAL	CONICAL

interference crossover tubes	YES	lambda sensor	NO	
header tube inner sleeves	S.S. CNC MACHINED	header tube flanges	ALU CNC MACHINED	
header tubes - collector connection	SLEEVE JOINT + SILICON SHIELDED SPRINGS	collector / header tube - link pipe connection	SLEEVE JOINT + SILICON SHIELDED SPRINGS	
link pipe - muffler connection	SLEEVE JOINT + SILICON SHIELDED SPRINGS	muffler inlet cap / outlet cap	TITANIUM / CARBON-FIBER	
muffler metal interior	TITANIUM	muffler outer sleeve	TITANIUM / CARBON-FIBER	
muffler clamp	CARBON-FIBER	muffler bracket	-	
muffler insert	EU	YES (track legal)	heat shield	-
	US	-	catalytic converter	NO

	ADDITIONAL DATA				
	stock	AKRAPOVIC		difference	
		S.S. link pipe	TITANIUM link pipe	stock - S.S.	stock - titanium
weight comparison (kg)	17.33	8.7	6.82	8.63	10.51

noise measurements (dB / rpm)	stock	AKRAPOVIC
	97 / 4750	99.4 / 4750 (with insert)
possibility of periodic service without removing A.E.S.	oil	oil filter
	YES	YES
legal for street use	NO	



Product code: S-K14R1-RC (108093), S-K14R1-RT (108092) racing
S-K14RFT1T-RC (108091), S-K14RFT-RT (108090) evolution



Product code: S-K14R1-RC (108093), S-K14R1-RT (108092) racing
S-K14RFT1T-RC (108091), S-K14RFT-RT (108090) evolution



Product code: S-K14R1-RC (108093), S-K14R1-RT (108092) racing
S-K14RFT1T-RC (108091), S-K14RFT-RT (108090) evolution

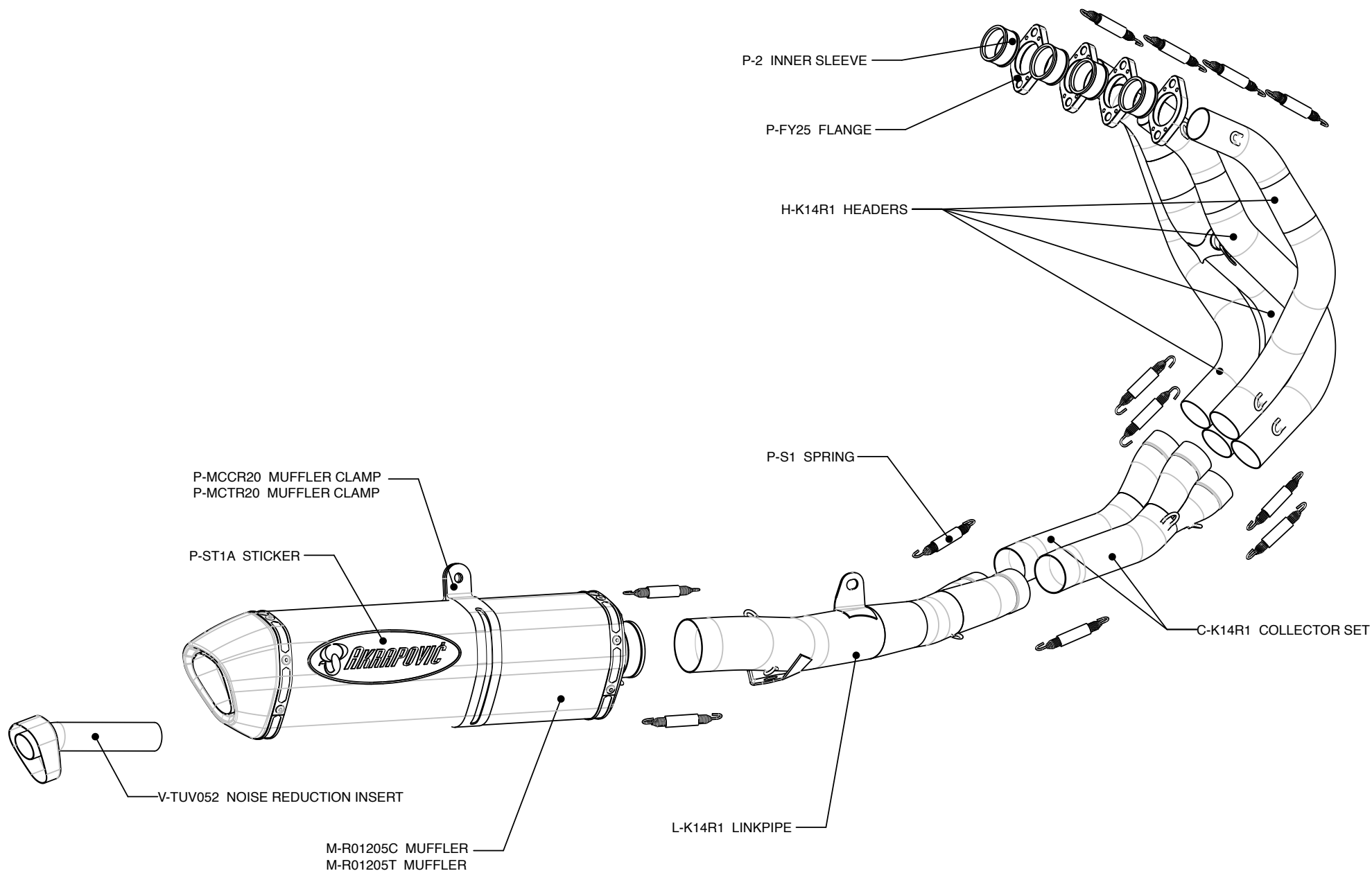

Product code: S-K14R1-RC (108093), S-K14R1-RT (108092) racing
S-K14RFT1T-RC (108091), S-K14RFT-RT (108090) evolution

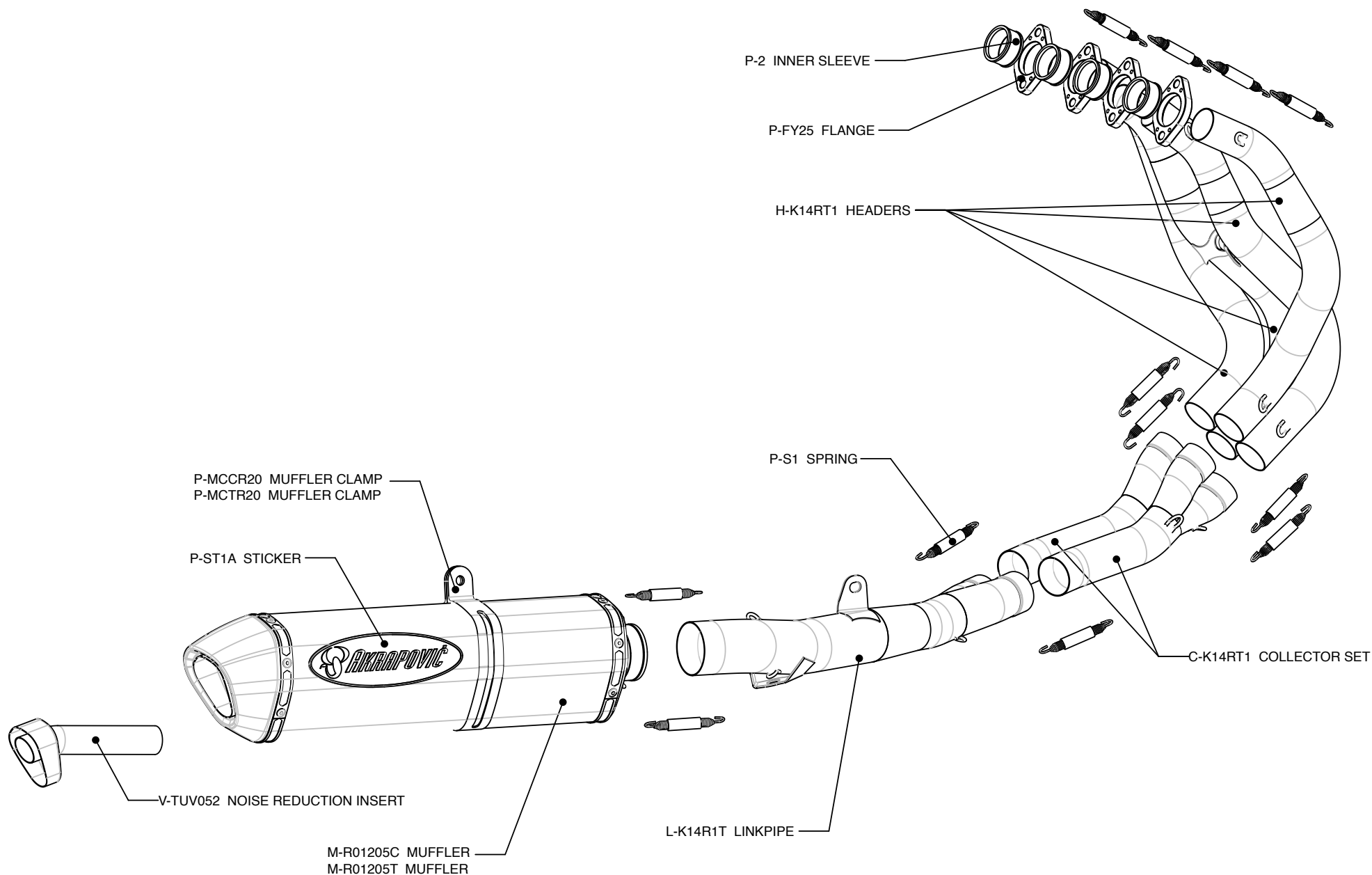

Product code: S-K14R1-RC (108093), S-K14R1-RT (108092) racing
 S-K14RFT1T-RC (108091), S-K14RFT-RT (108090) evolution

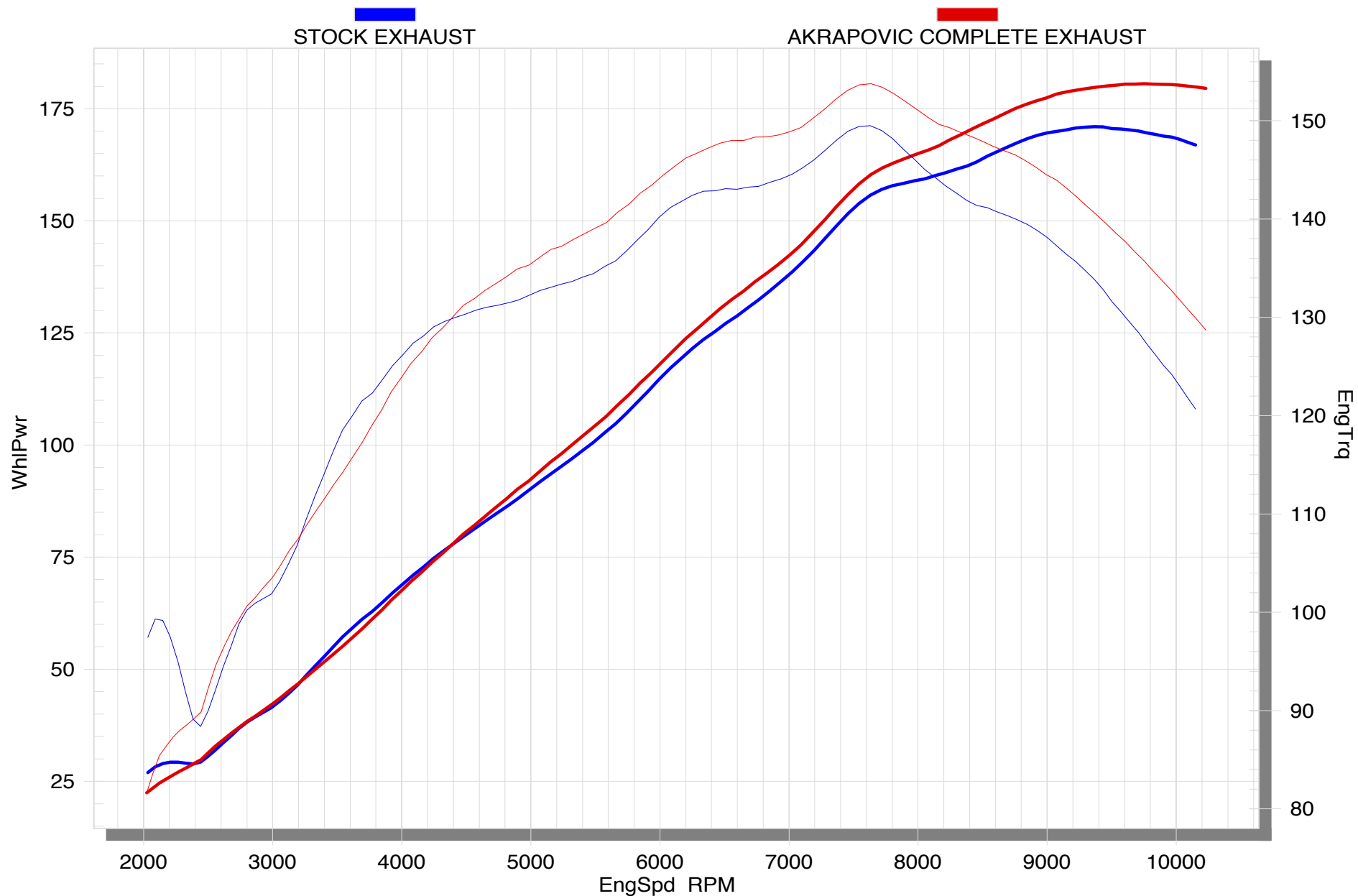

Product code: S-K14R1-RC (108093), S-K14R1-RT (108092) racing
 S-K14RFT1T-RC (108091), S-K14RFT-RT (108090) evolution