



Suzuki SV 1000, SV 1000 S (2003)

Bolt-On Exhaust System

Akrapovic Bolt-On Exhaust System

for the Suzuki SV 1000, SV 1000 S (2003)

Suzuki's popular twin. The engine from the TL model has been upgraded to keep up with the times and offers excellent performance characteristics. In combination with the technically modern frame it is a motorcycle which can be rode both hard and leisurely. No matter which model you choose, totally naked or with a half-fairing, the bike is going to attract a lot of attention.

GOAL

There is no doubt that this is a good-looking bike. By installing a well-known exhaust component like the Akrapovic, you will be telling everyone that besides an eye for looks, you have a taste for quality and know-how acquired through years of cooperation with top racing teams. The excellent twin will receive an enhanced sound and a significant boost in performance; a first-stage exhaust tuning with a minimal installation procedure – the Akrapovic BOLT-ON exhaust system.

ABOUT AKRAPOVIC BOLT-ON SYSTEMS:

The Akrapovic BOLT-ON system is made of top quality materials – the inner perforated sleeve and end cap of the muffler are made of titanium, while the muffler front rosette is CNC machined from special billet aluminum in order to achieve minimum weight with maximum compactness and durability.

The construction of the system is based mainly on simple installation which can be performed by the customer, without having to remove or modify any of the exterior parts of the motorcycle. It is also a custom-designed component which is not intended for use on any other type of motorcycle. Installation is performed simply by removing the bolts from the stock muffler and bolting on the Akrapovic BOLT-ON system; in the case of the SV 1000 on both sides of the bike.

The outer sleeve of the muffler is available in either the racing-style black checkered pattern of carbon-fiber or the elegant satin sheen of titanium. The muffler clamps are made entirely of carbon-fiber. Your BOLT-ON system kit will include the appropriate number of titanium bolts to replace the stock bolts, and special temperature-resistant bolt sealant to prevent the bolts from unseating.

Measurements of the BOLT-ON system for the Suzuki SV 1000 S:

•power:

First-level exhaust system tuning will not give you an extreme performance improvement. However, as can be seen from the power curve, the engine will breathe more easily with the Akrapovic BOLT-ON system. The greatest increase occurs in the middle of the rpm range, and there is also a boost at the top of the range. Here, at 9250 rpm, the rear wheel will receive 113 HP.

•torque:

The engine's being less choked-off will also be reflected in the torque curve. Again, the middle of the rpm range is most enhanced, which will result in a more comfortable ride and easier shifting. And of course this will suit the Suzuki SV, with its major reserves of power, to a T.

The Akrapovic BOLT-ON system will therefore offer a performance increase at the limits of first-level tuning. Its aesthetic impact will be even greater, since it fits exceptionally well into the exterior lines of the SV and gives the finishing touch to the racing-style raised back end of the bike.

The weight savings is yet another reason to choose the Akrapovic BOLT-ON system, since by installing it you will reduce the overall weight of the motorcycle by 5.11 kg. And as far as the sound is concerned the answer is clear: the tone is deeper and more intense no matter what side of the bike you're standing on.

	stock	AKRAPOVIC	difference
weight comparison	8.71 kg	3.60 kg	5.11 kg
max. rear wheel power	111 HP / 9200 RPM	113 HP / 9250 RPM	3 HP / 6500 RPM*
noise measurement			
Left	92 db / 4500 RPM	97.6 db / 4500 RPM	5.6 db / 4500 RPM
Right	92 db / 4500 RPM	97.6 db / 4500 RPM	5.6 db / 4500 RPM
legal for street use	NO		

*MAXIMUM MEASURED POWER DIFFERENCE

Technical specifications of Akrapovic exhaust systems and related products subject to change without notice.

Product code: S-S10BO2-C, S-S10BO2-T

Akrapovic Bolt-On Exhaust System for the Suzuki SV 1000, SV 1000 S (2003)



Road
Program

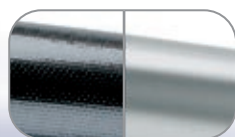

The outer sleeve is available in carbon-fiber or titanium



CARBON-FIBER
MUFFLER CLAMP

Product code: S-S10B02-C, S-S10B02-T



Akrapovic Bolt-On Exhaust System for the Suzuki SV 1000, SV 1000 S (2003)



Akrapovic Exhaust System Technology copyright 2003, all rights reserved

Road
Program

Product code: S-S10B02-C, S-S10B02-T

Akrapovic Bolt-On Exhaust System for the Suzuki SV 1000, SV 1000 S (2003)



Akrapovic Exhaust System Technology copyright 2003, all rights reserved

Road Program

Product code: S-S10BO2-C, S-S10BO2-T

Akrapovic Bolt-On Exhaust System

for the Suzuki SV 1000, SV 1000 S (2003)

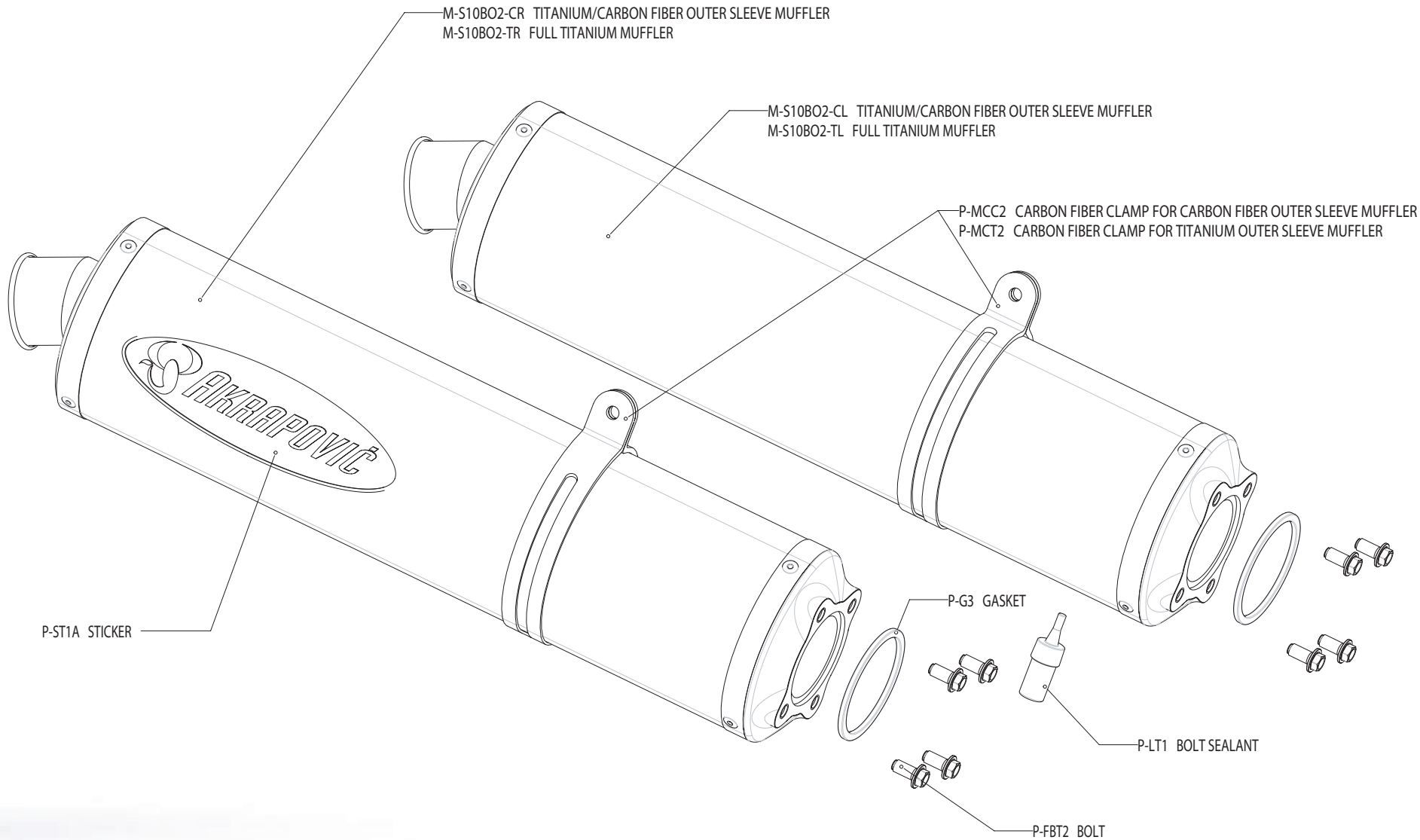

Akrapovic Exhaust System Technology copyright 2003, all rights reserved

Road Program



Akrapovic Bolt-On Exhaust System

for the Suzuki SV 1000, SV 1000 S (2003)

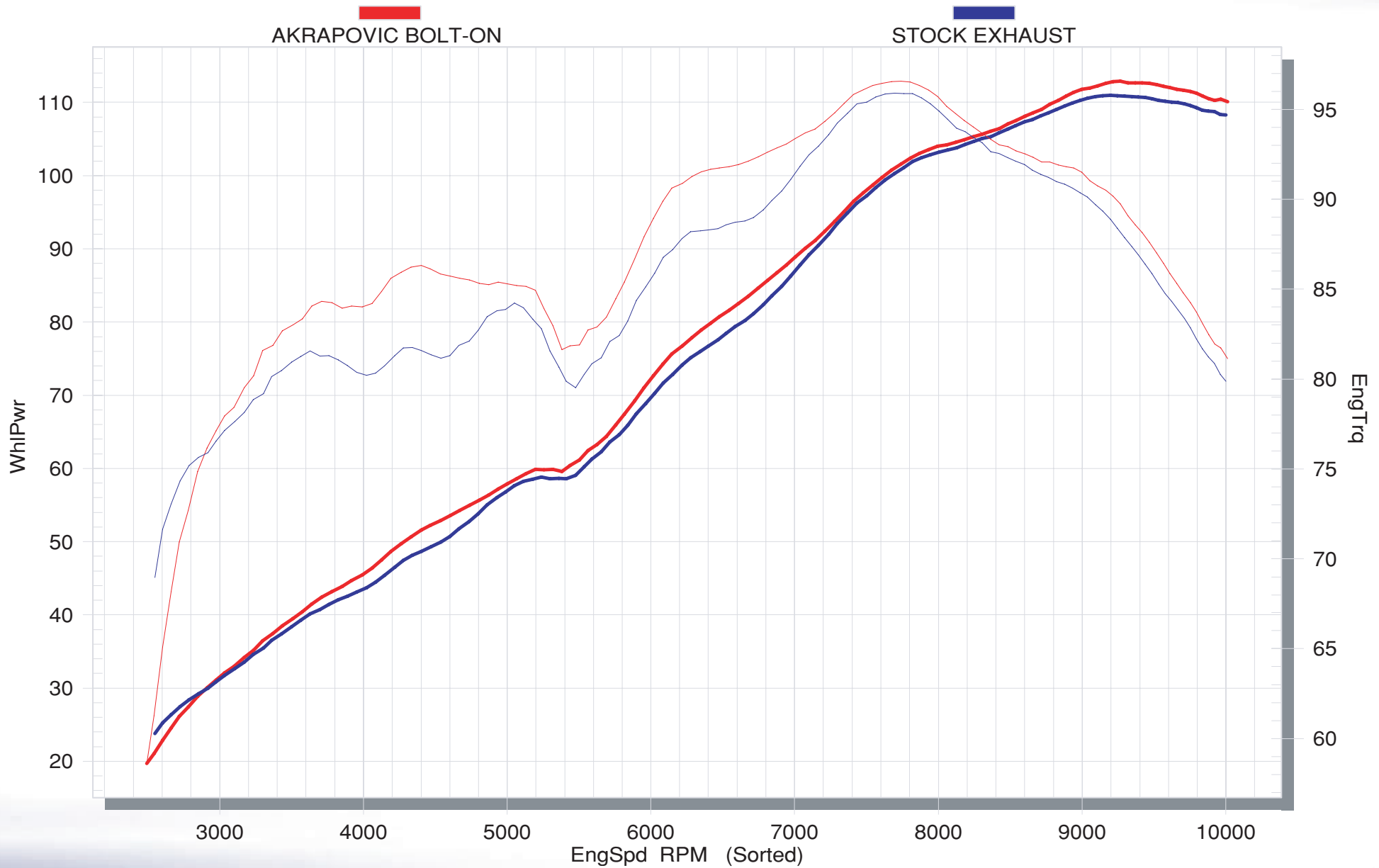

Akrapovic Exhaust System Technology copyright 2003, all rights reserved

Road Program

Product code: S-S10BO2-C, S-S10BO2-T

