



SUZUKI RM-Z 250

(2008 - 2009)

SLIP-ON EXHAUST SYSTEM

www.akrapovic.com

This Akrapovic Slip-On partial system is designed for recreational riders of the RMZ. Riders who are looking for a highest performance system should see our Akrapovic Racing and Evolution complete systems. The Akrapovic Slip-On is an excellent combination of quality workmanship, performance and affordability. For the European and other non-US markets it is equipped with a built-in noise damper, and for the American market it comes with an approved spark arrester.

PERFORMANCE

Measurements of the Akrapovic SLIP-ON system on the SUZUKI RM-Z 250 (with muffler insert):

Power & Torque: the Akrapovic Slip-On system offers a significant increase in the performance of the Suzuki engine. The improvement can be felt in the middle and top ends of the rpm range, with increases in both power and torque. At 11600 rpm we measured 34.6 HP, with max. increased power of 1.6 HP at 10700 rpm.

CONFIGURATION

The system is composed of a flared stainless steel link pipe which is welded to the muffler. It is attached to the stock header assembly with a sleeve joint secured with a metal clamp. The muffler outer sleeve is made of titanium, while the inlet cap, outlet cap and perforated inner sleeve are made of stainless steel because of the weld with the link pipe. The muffler is attached to the frame with an Akrapovic offroad carbon-fiber clamp. It is designed for two markets: for the European and other non-US markets it is equipped with a built-in noise damper, and for the American market it comes with an approved spark arrester.

	PERFORMANCE		
	stock	AKRAPOVIC	max. increased power
max. rear wheel power HP / rpm <small>(measured on Dynojet ATV)</small>	34.1 / 11680	34.6 / 11600	1.6 / 10700

	CONFIGURATION		
	header tubes	collector	link pipe
material	-	-	STAINLESS STEEL
tube shape	-	-	flared

interference crossover tubes	-	lambda sensor	-
header tube inner sleeves	-	header tube flanges	-
header tubes - collector connection	-	collector / header tube - link pipe connection	SLEEVE JOINT + GRAPHITE GASKET+ METAL CLAMP
link pipe - muffler connection	WELDED	muffler inlet cap /outlet cap	S.S. / S.S.
muffler metal interior	STAINLESS STEEL	muffler outer sleeve	TITANIUM
muffler clamp	CARBON-FIBER	muffler bracket	-
muffler insert	EU	NOISE DAMPER	-
	US	YES	catalytic converter

	ADDITIONAL DATA				
	stock	AKRAPOVIC		difference	
		S.S. link pipe	TITANIUM link pipe	stock - S.S.	stock - titanium
weight comparison (kg)	3	2	-	1	-

noise measurements (dB / rpm)	stock	AKRAPOVIC
	94 \ 5000	94 \ 5000
possibility of periodic service without removing A.E.S.	oil	oil filter
	YES	YES
legal for street use	NO	

Technical specifications of Akrapovic exhaust systems and related products subject to change without notice.



Product code: (108811) S-S2SO2-MT
(106729) S-S2SO1-MTA spark arrester





Product code: (108811) S-S2SO2-MT
(106729) S-S2SO1-MTA spark arrester



www.akrapovic.com

Akrapovic d.d. 2009 all rights reserved
11.03.2009



Product code: (108811) S-S2SO2-MT
(106729) S-S2SO1-MTA spark arrester

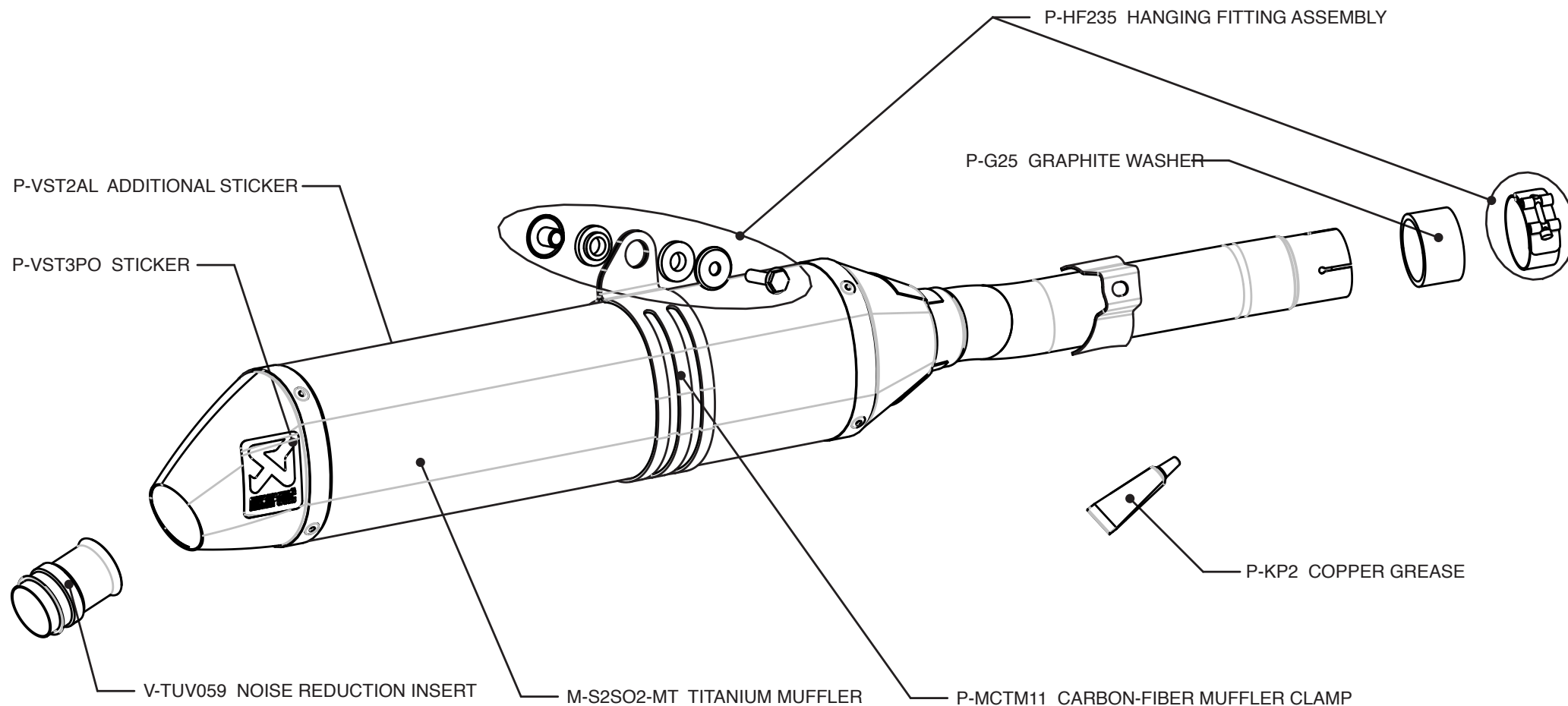

Product code: (108811) S-S2SO2-MT
(106729) S-S2SO1-MTA spark arrester

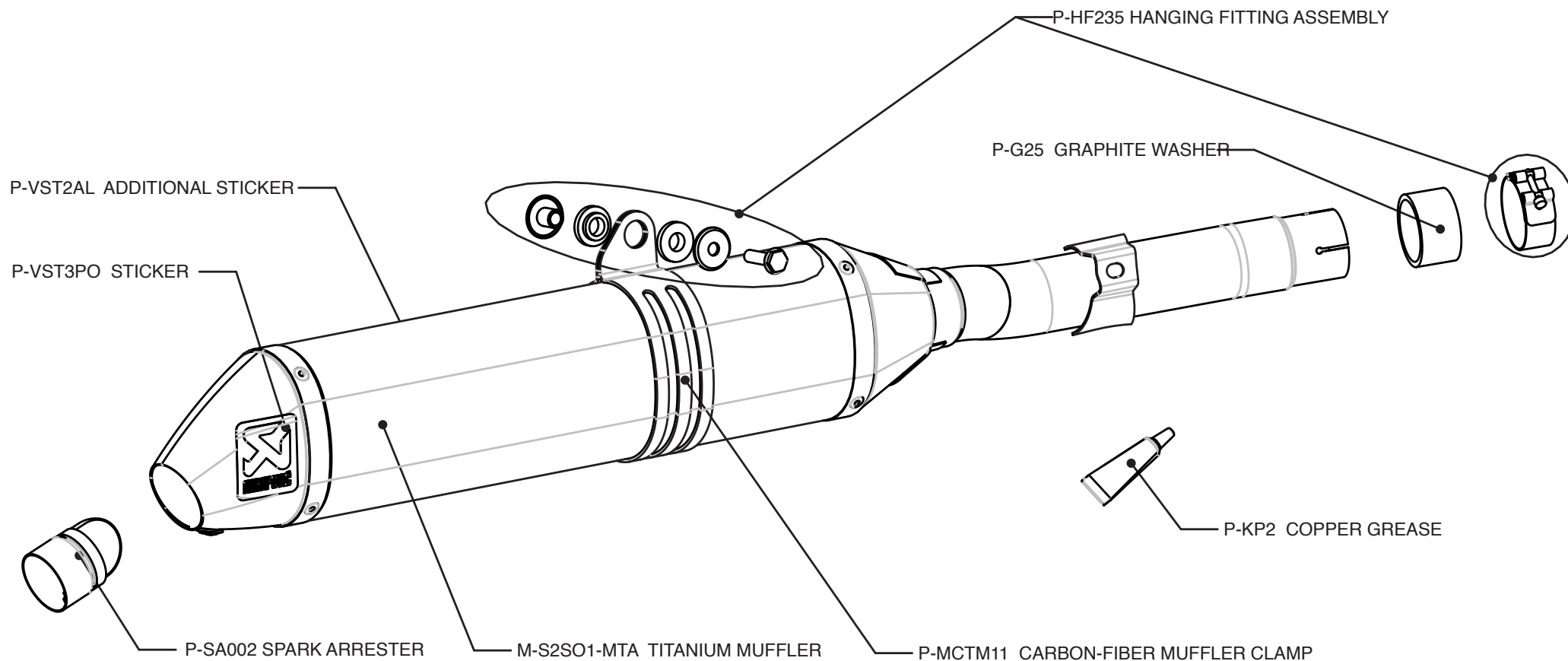

Product code: (108811) S-S2SO2-MT
(106729) S-S2SO1-MTA spark arrester

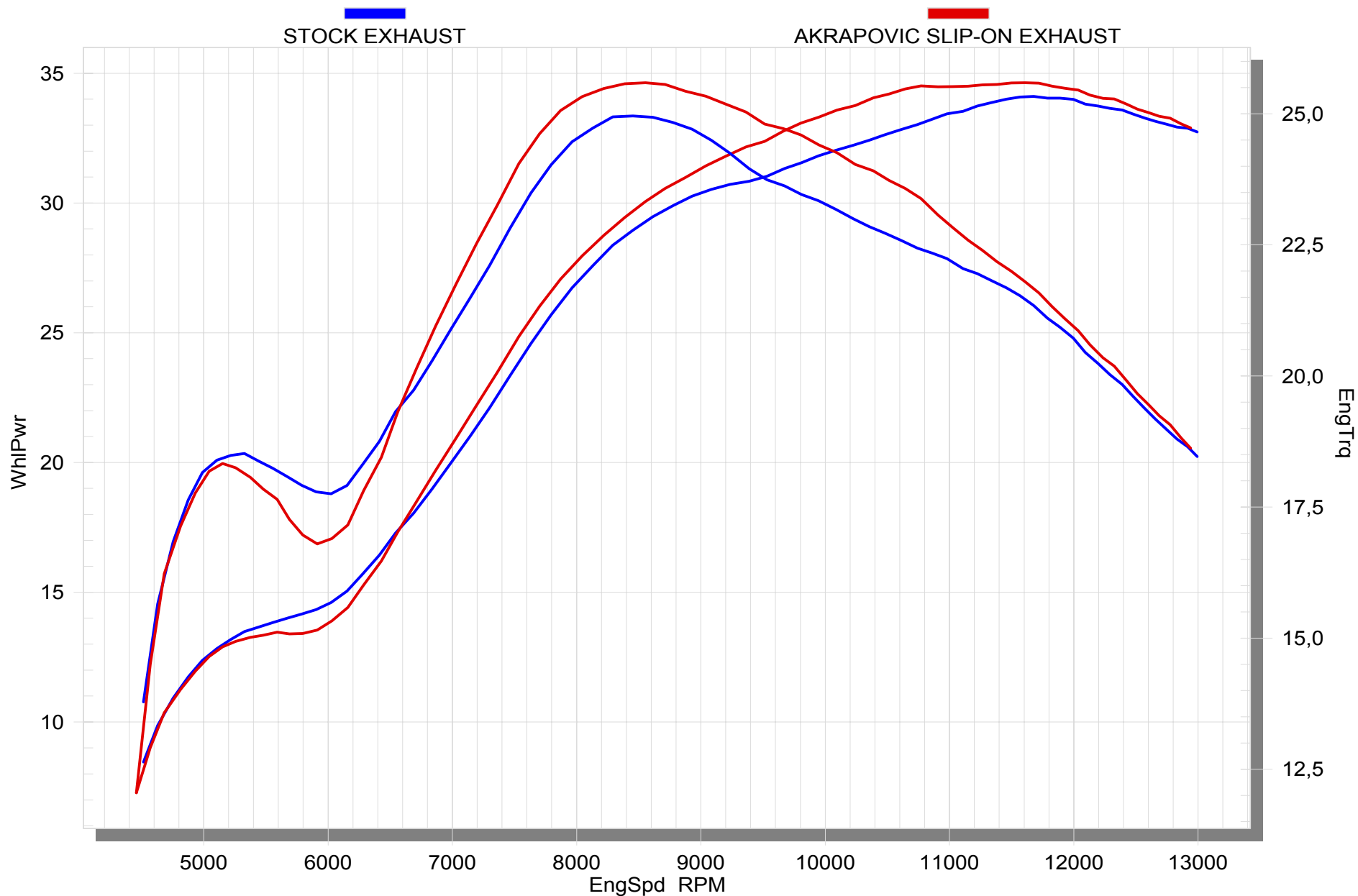

Product code: (108811) S-S2SO2-MT
 (106729) S-S2SO1-MTA spark arrester



www.akrapovic.com

Akrapović d.d. 2009 all rights reserved
 11.03.2009