



Yamaha YZ 250F (2007)

Slip-On Exhaust System

Akrapovic Slip-On Exhaust System

for the Yamaha YZ 250 (2007)

The Akrapovic Slip-On system was designed to improve engine performance in the most effective part of the rpm range and improve riding characteristics for recreational MX riders. More demanding riders should see our Akrapovic Racing and Evolution complete system. The Akrapovic Slip-On system includes a noise damper for the European market, and an approved spark arrester for the US market.

PERFORMANCE

Measurements of the Akrapovic SLIP-ON system on the YAMAHA YZ 250F (with muffler insert):

Power & Torque: the Akrapovic Slip-On was designed for recreational riders. The most significant engine performance upgrade comes in the top of the range and the over-rev range, i.e. between 8000 and 13000 rpm. Max. power was 36.7 HP at 11650. Max. increased power was 2.1 HP at 11650 rpm.

CONFIGURATION

The Akrapovic Slip-On system for the Yamaha comes from our offroad MX / Enduro group, as can be seen from its design. It is composed of a conical stainless steel link pipe which is welded to the muffler. It is attached to the stock header assembly with a sleeve joint secured with a metal clamp. The inlet cap is made of stainless steel due to the connection to the link pipe, as is the outlet cap. The inner perforation is also made of stainless steel. The muffler outer sleeve is made of titanium. The system is attached to the motorcycle with an Akrapovic carbon-fiber clamp. The system includes a noise damper for the European market, and an approved spark arrester for the US market, which is indicated on the muffler with a laser engraving.

	PERFORMANCE		
	stock	AKRAPOVIC	max. increased power
max. rear wheel power HP / rpm (measured on Dynojet ATV)	35 / 10750	36.7 / 11650	2.1 / 11650

	CONFIGURATION		
	header tubes	collector	link pipe
material	-	-	STAINLESS STEEL
tube shape	-	-	CONICAL

interference crossover tubes	-	lambda sensor	NO
header tube inner sleeves	-	header tube flanges	-
header tubes - collector connection	-	collector / header tube - link pipe connection	SLEEVE JOINT + GRAPHITE GASKET + METAL CLAMP
link pipe - muffler connection	WELDED	muffler inlet cap / outlet cap	STAINLESS STEEL
muffler metal interior	STAINLESS STEEL	muffler outer sleeve	TITANIUM
muffler clamp	CARBON-FIBER	muffler bracket	-
muffler insert	EU	NOISE DAMPER	heat shield
	US	SPARK ARRESTER	catalytic converter
			NO

	ADDITIONAL DATA				
	stock	AKRAPOVIC		difference	
weight comparison (kg)	2.75	RACING	EVOLUTION	stock - RACING	stock - EVOLUTION
		2.04	-	0.71	-
noise measurements (dB / rpm)	stock		AKRAPOVIC		
	96 / 5000		96 / 5000		
possibility of periodic service without removing A.E.S.	oil		oil filter		
	YES		YES		
legal for street use	NO				

Technical specifications of Akrapovic exhaust systems and related products subject to change without notice.

Product code: 107380 (S-Y2SO3-MT)
107382 (S-Y2SO3-MT) US market

Akrapovic Slip-On Exhaust System for the Yamaha YZ 250 (2007)



CARBON-FIBER
MUFFLER CLAMPS



Off-Road
Program

Product code: 107380 (S-Y2SO3-MT)
107382 (S-Y2SO3-MT) US market

Akrapovic Slip-On Exhaust System for the Yamaha YZ 250 (2007)



Akrapovic Exhaust System Technology copyright 2007, all rights reserved

Off-Road
Program

Product code: 107380 (S-Y2SO3-MT)
107382 (S-Y2SO3-MT) US market

Akrapovic Slip-On Exhaust System for the Yamaha YZ 250 (2007)



Akrapovic Exhaust System Technology copyright 2007, all rights reserved

Off-Road
Program

Product code: 107380 (S-Y2SO3-MT)
107382 (S-Y2SO3-MT) US market

Akrapovic Slip-On Exhaust System for the Yamaha YZ 250 (2007)

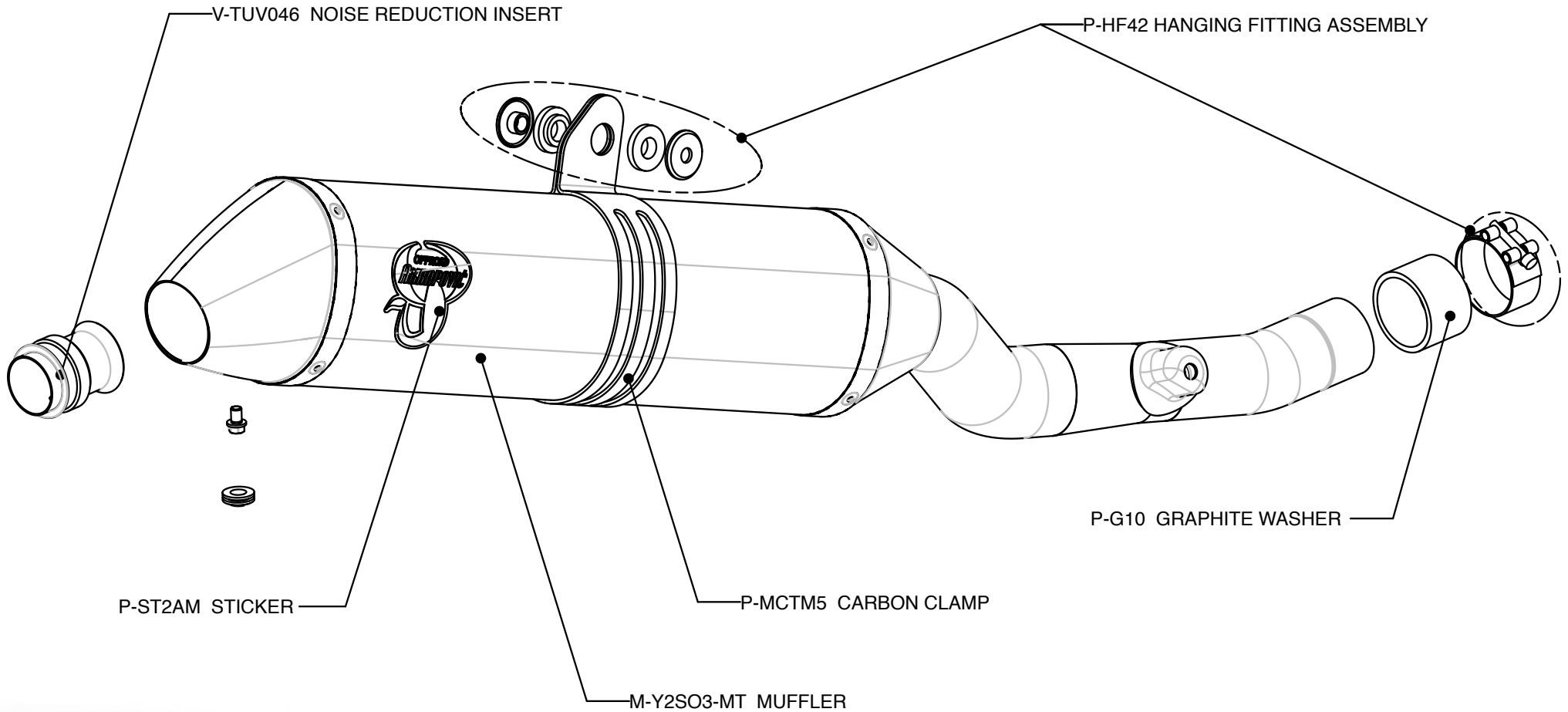

Akrapovic Exhaust System Technology copyright 2007, all rights reserved

Off-Road
Program

Product code: 107380 (S-Y2SO3-MT)

Akrapovic Slip-On Exhaust System for the Yamaha YZ 250 (2007)

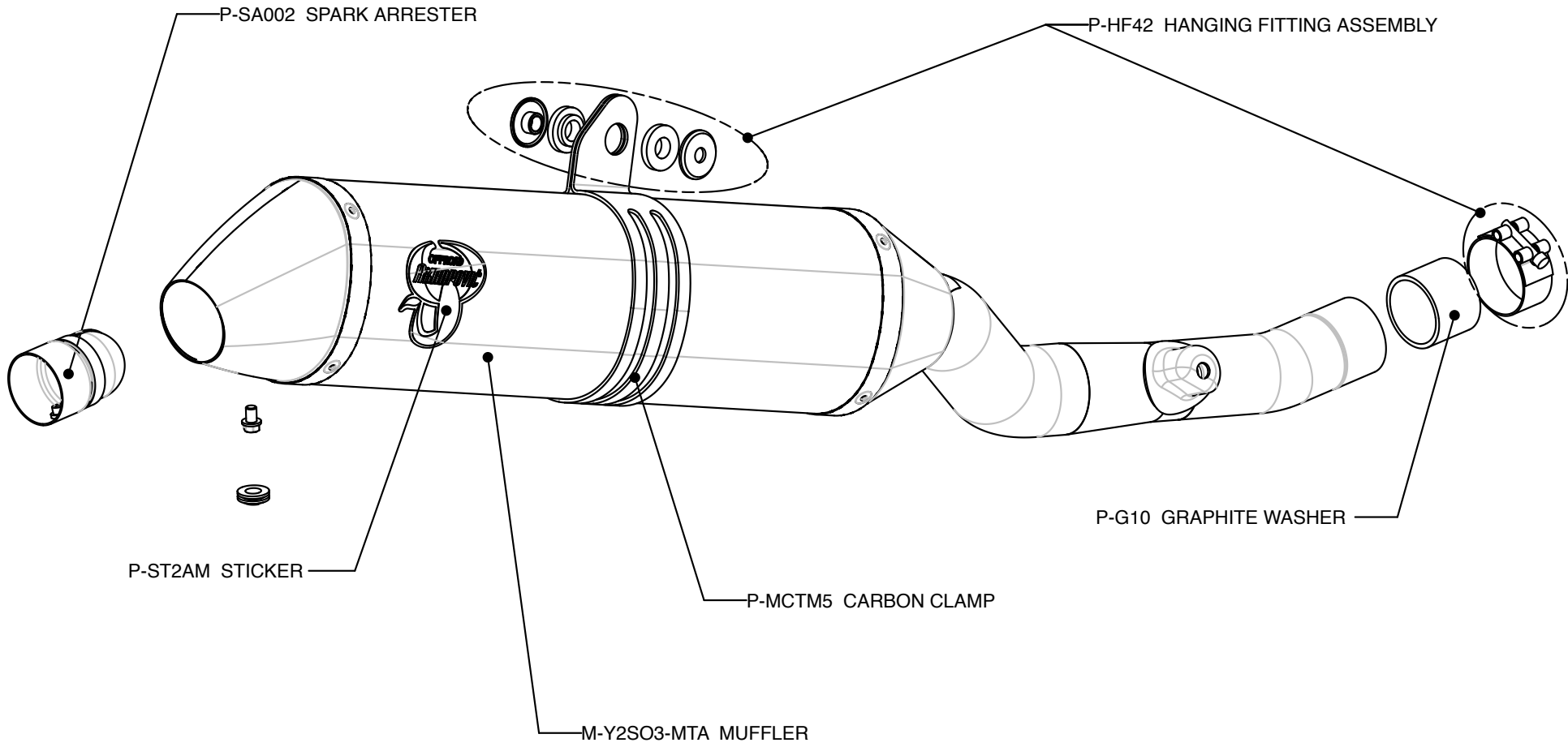

Off-Road
Program

Product code: 107382 (S-Y2SO3-MT) US market



Akrapovic Exhaust System Technology copyright 2007, all rights reserved

Akrapovic Slip-On Exhaust System

for the Yamaha YZ 250 (2007)

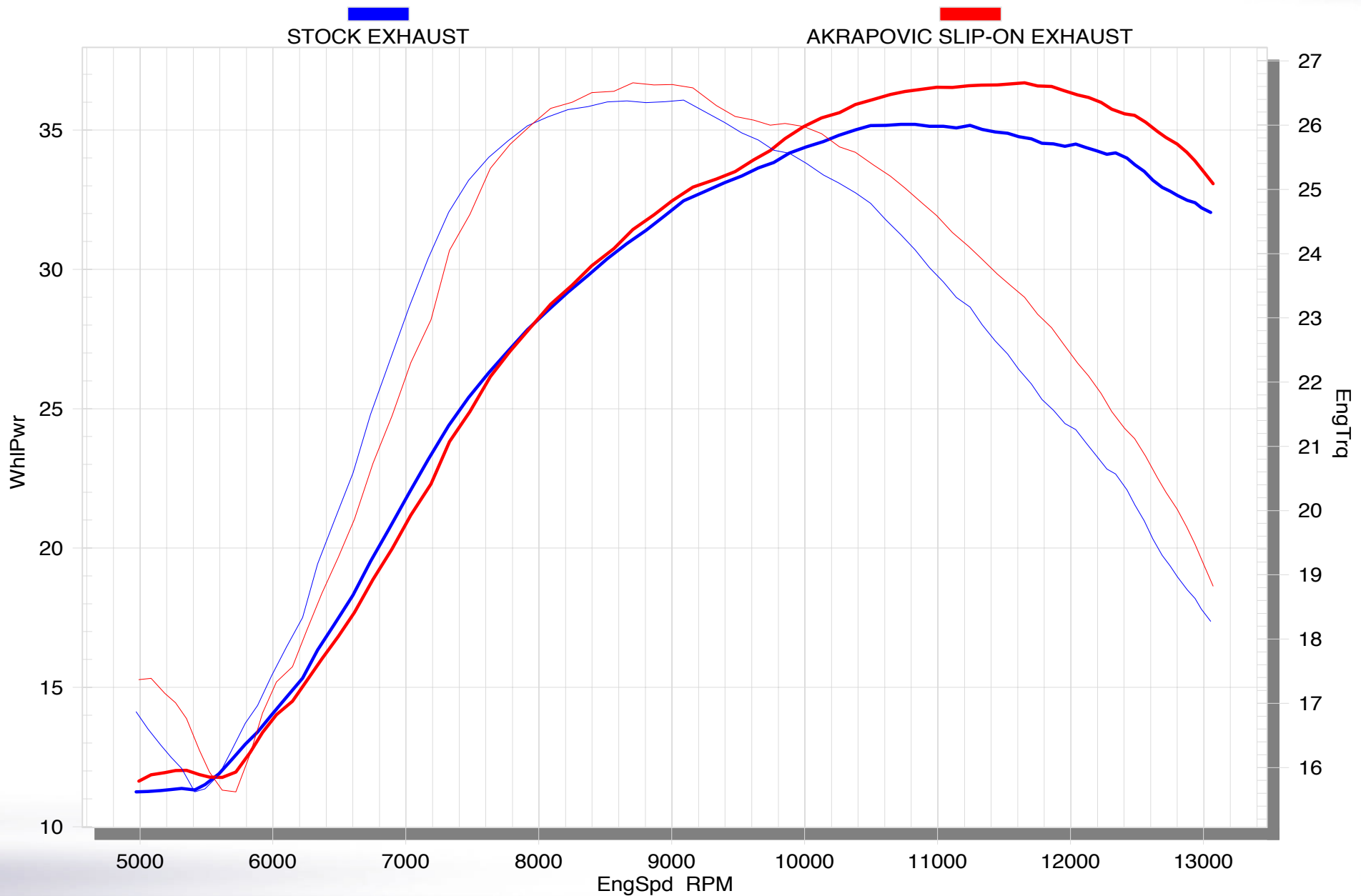

Off-Road Program

Product code: 107380 (S-Y2SO3-MT)
107382 (S-Y2SO3-MT) US market



Akrapovic Exhaust System Technology copyright 2007, all rights reserved