



YAMAHA YZ 450F

(2008)

RACING & EVOLUTION EXHAUST SYSTEM

www.akrapovic.net

The Akrapovic Racing and Evolution exhaust systems with their hexagonal mufflers are the top of the line product, and are designed for riders who know how to get the most out of their equipment. The increases in power and torque can be clearly seen from the dyno measurements and clearly felt when riding the bike. The muffler includes additional chamber on header pipe a noise damper for the European market, and an approved spark arrester for the US market.

PERFORMANCE

Measurements of the Akrapovic EVOLUTION system on the YAMAHA YZ 450F (with muffler insert):

Power & Torque: the Akrapovic Racing and Evolution systems provide the increased performance that top riders are looking for. Engine performance is increased throughout the entire rpm range, most significantly in the upper part of power curve. We measured max. increase of power of 3.4 HP at 9250 rpm.

CONFIGURATION

The Akrapovic Racing and Evolution systems come with the unique Hexagonal offroad design muffler. They differ only in their selection of tubing material: the Racing uses stainless steel, and the Evolution uses titanium. The conical header tube is made of stainless steel (Racing) or titanium (Evolution), and includes an additional chamber which reduces engine noise and adds increased power in the low rpm range. It is attached to the conical link pipe with a sleeve joint secured with a silicon-shielded spring. The link pipe is welded to the muffler. The inlet cap and the inner perforation are made of the same material as the link pipe, i.e. stainless steel (Racing) or titanium (Evolution). The outlet cap is made of carbon-fiber for evolution and composite polymer for Racing system. The muffler outer sleeve is available in either titanium or carbon-fiber. The system is attached to the motorcycle with Akrapovic carbon-fiber clamps. It also includes an Akrapovic carbon-fiber heat shield. The system includes a noise damper for the European market, and an approved spark arrester for the US market, which is indicated on the muffler with a laser engraving.

Technical specifications of Akrapovic exhaust systems and related products subject to change without notice.

	PERFORMANCE		
	stock	AKRAPOVIC	max. increased power
max. rear wheel power HP / rpm <small>(measured on Dynojet ATV)</small>	46.8 / 8350	48.9 / 8600	3.4 / 9250

	CONFIGURATION		
	header tubes	collector	link pipe
material	S.S / Ti	-	S.S / Ti
tube shape	CONICAL	-	CONICAL

interference crossover tubes	NO (Chamber)	lambda sensor	-	
header tube inner sleeves	S.S. CNC machined	header tube flanges	ALU CNC machined	
header tubes - collector connection	-	collector / header tube - link pipe connection	SLEEVE JOINT + SILICON SHIELDED SPRING	
link pipe - muffler connection	WELDED	muffler inlet cap /outlet cap	S.S. - Ti / composite polymer -Ti	
muffler metal interior	S.S. / Ti	muffler outer sleeve	Ti / Ti or carb.fiber	
muffler clamp	CARBON-FIBER	muffler bracket	-	
muffler insert	EU	YES	heat shield	Carbon fiber
	US	YES	catalytic converter	NO

	ADDITIONAL DATA				
	stock	AKRAPOVIC		difference	
		racing	evolution	stock - racing	stock - evolution
weight comparison (kg)	4.5	2.88	2.27	1.62	2.23

noise measurements (dB / rpm)	stock	AKRAPOVIC
	94 / 4500	94 / 4500
possibility of periodic service without removing A.E.S.	oil	oil filter
	YES	YES
legal for street use	NO	

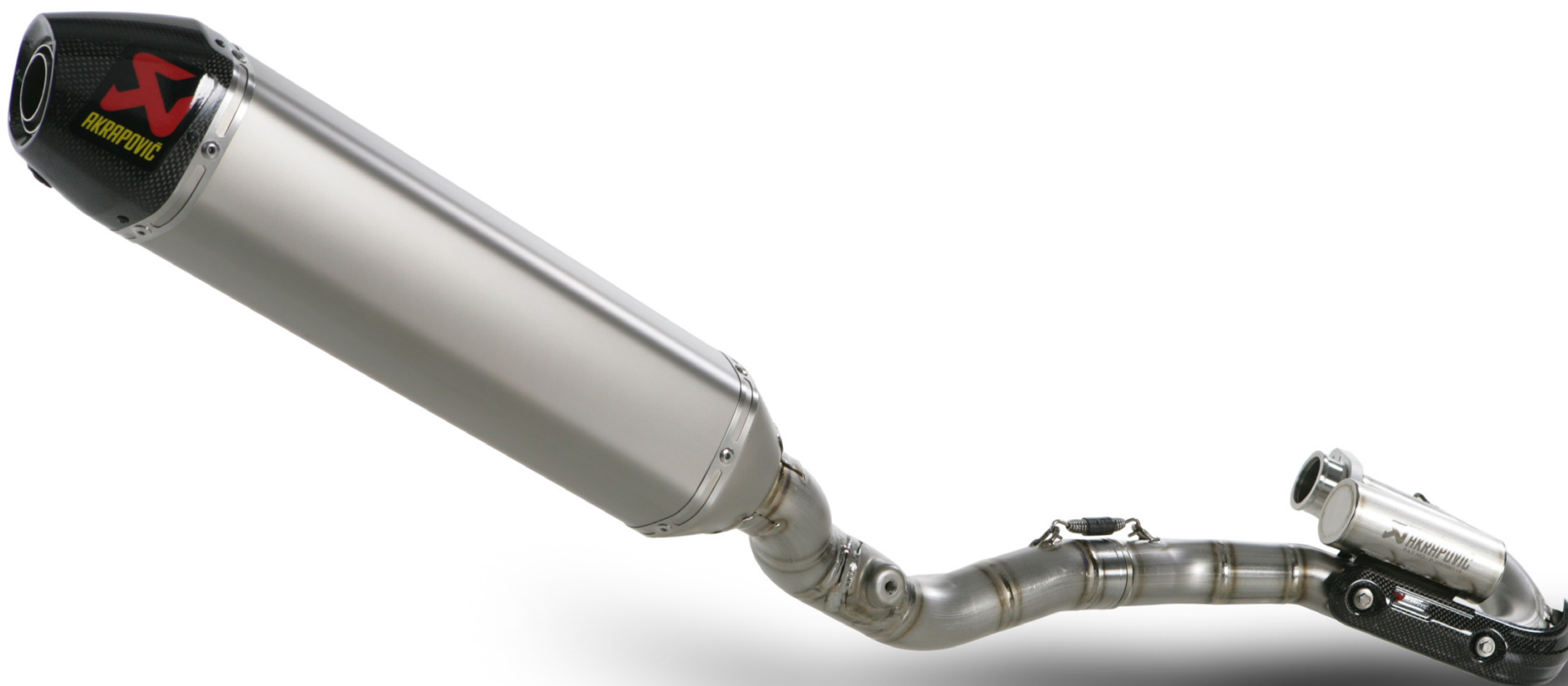

Product code: S-Y4MR8-QT racing, S-Y4MR8-QTA racing US market
S-Y4MET8-QT evolution, S-Y4MET8-QT evolution US market



Product code: S-Y4MR8-QT racing, S-Y4MR8-QTA racing US market
S-Y4MET8-QT evolution, S-Y4MET8-QT evolution US market



Product code: S-Y4MR8-QT racing, S-Y4MR8-QTA racing US market
S-Y4MET8-QT evolution, S-Y4MET8-QT evolution US market

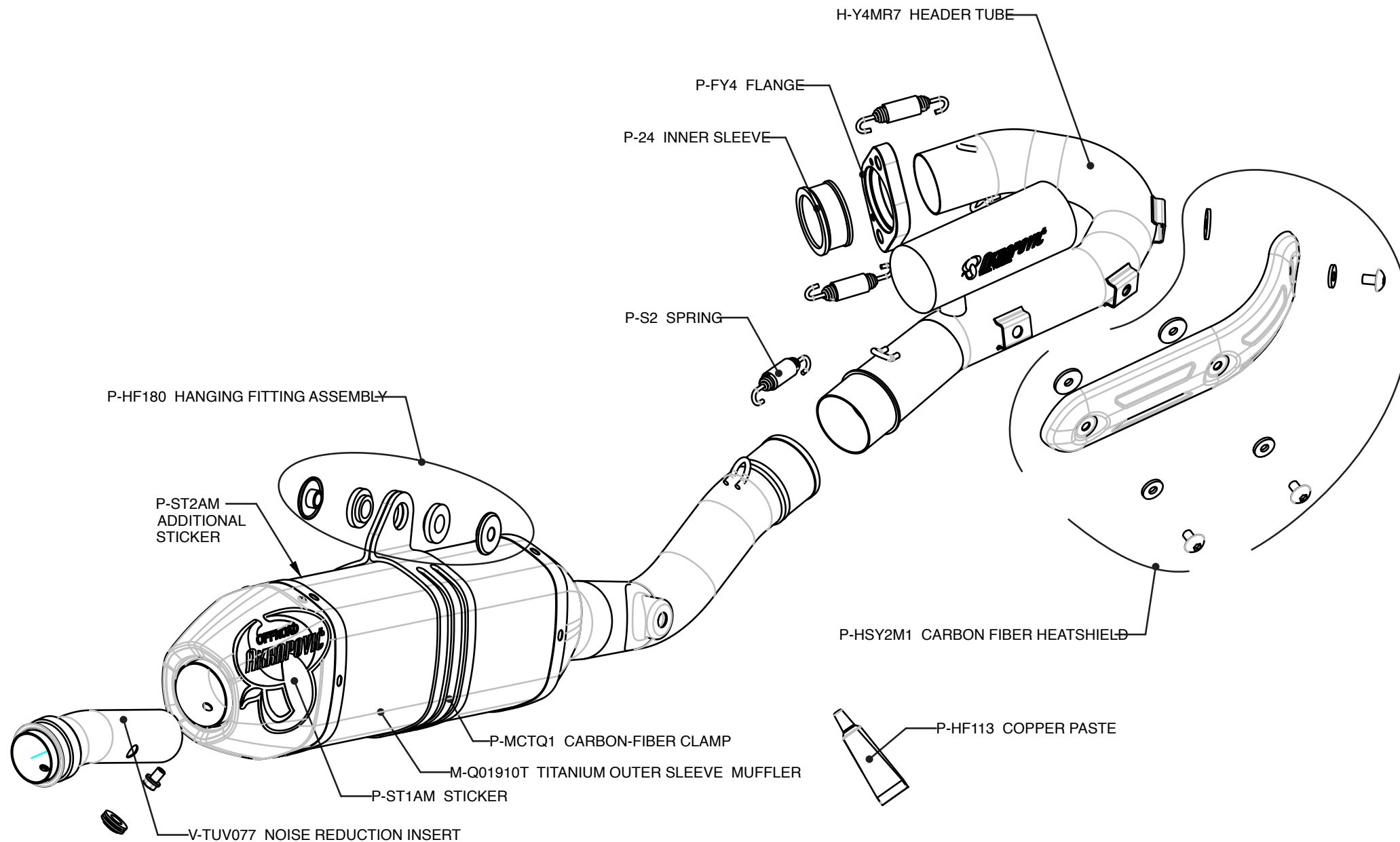

Product code: S-Y4MR8-QT racing, S-Y4MR8-QTA racing US market
 S-Y4MET8-QT evolution, S-Y4MET8-QT evolution US market

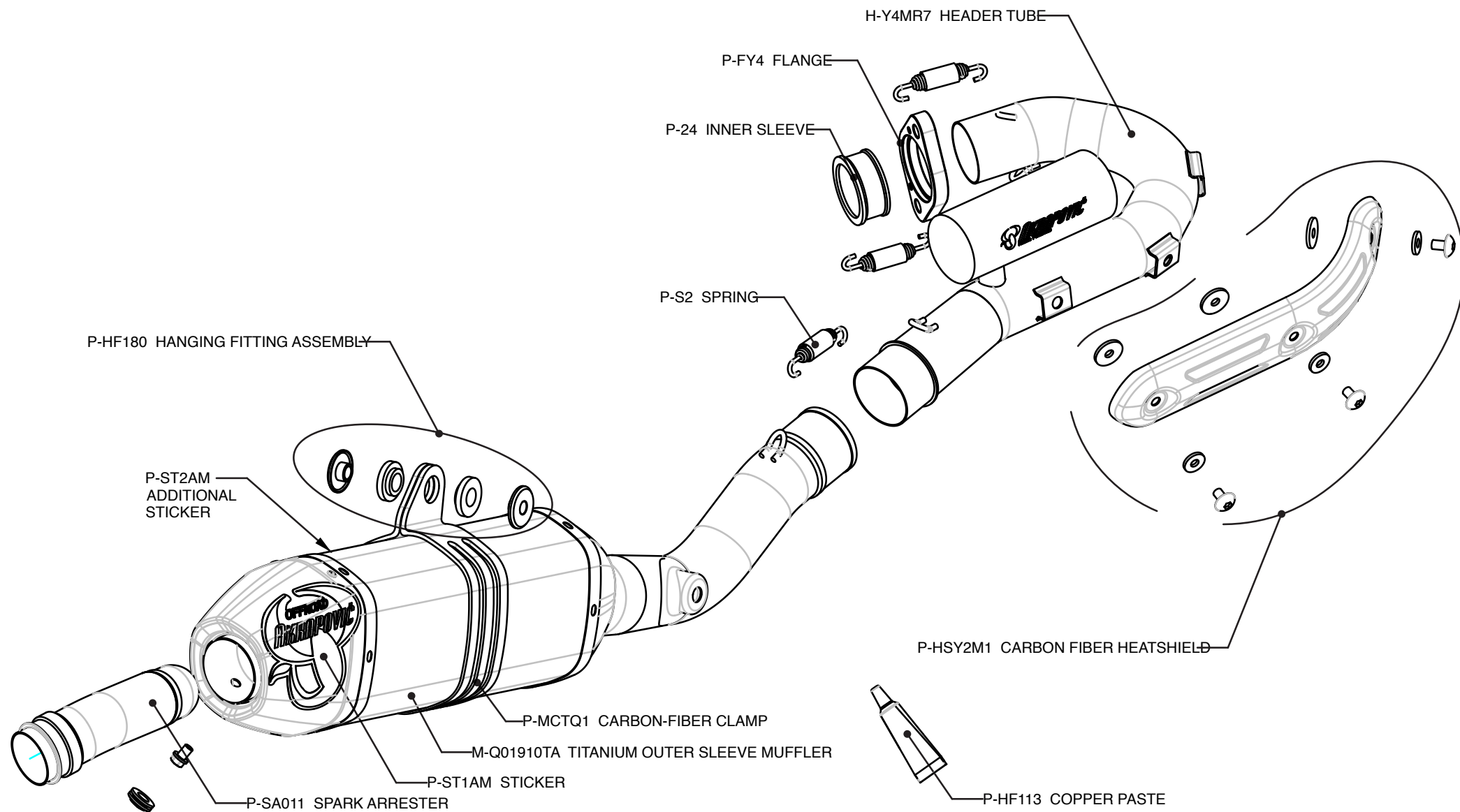

Product code: S-Y4MR8-QT racing, S-Y4MR8-QTA racing US market
 S-Y4MET8-QT evolution, S-Y4MET8-QT evolution US market

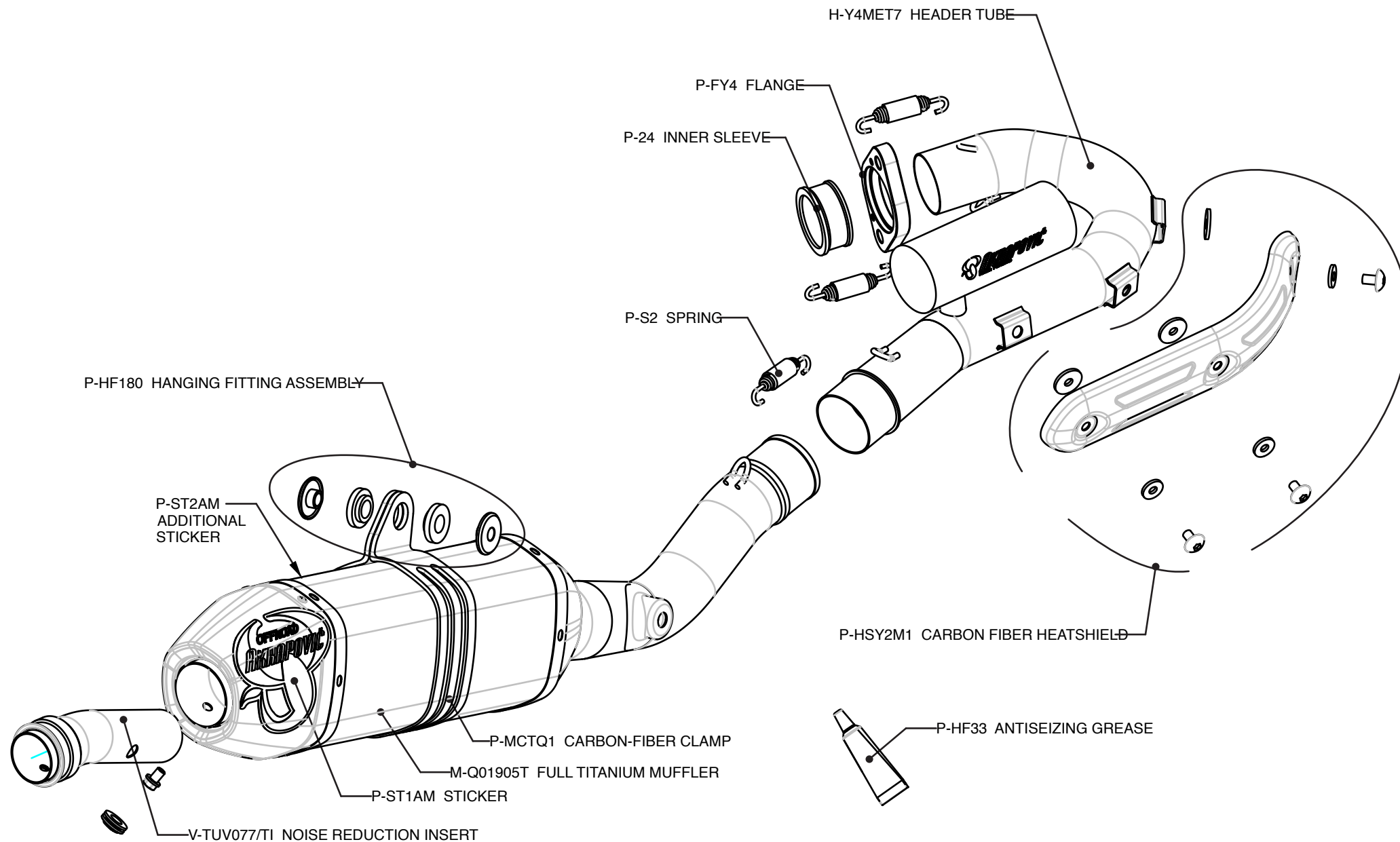

Product code: S-Y4MR8-QT racing, S-Y4MR8-QTA racing US market
 S-Y4MET8-QT evolution, S-Y4MET8-QT evolution US market

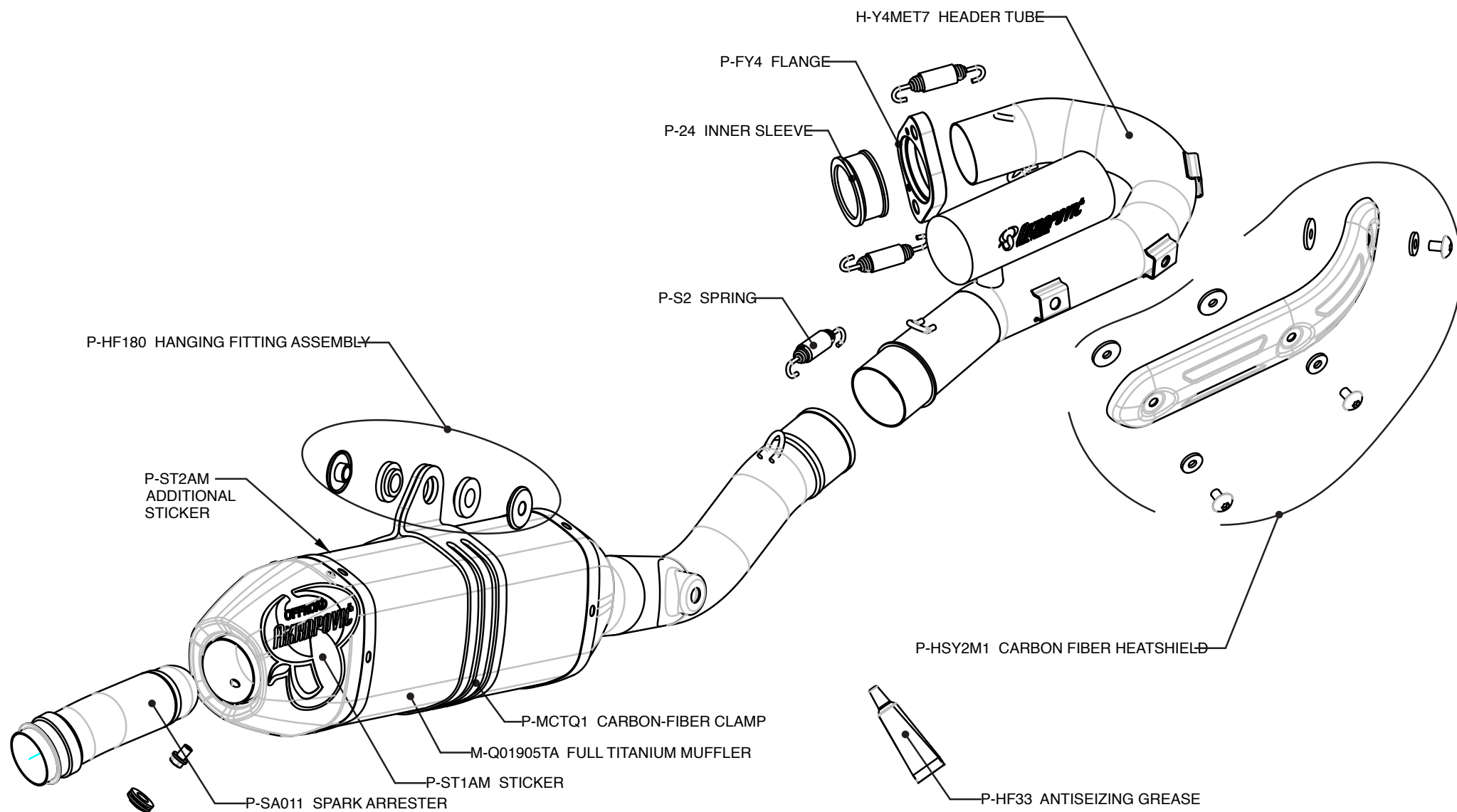

Product code: S-Y4MR8-QT racing, S-Y4MR8-QTA racing US market
 S-Y4MET8-QT evolution, S-Y4MET8-QT evolution US market

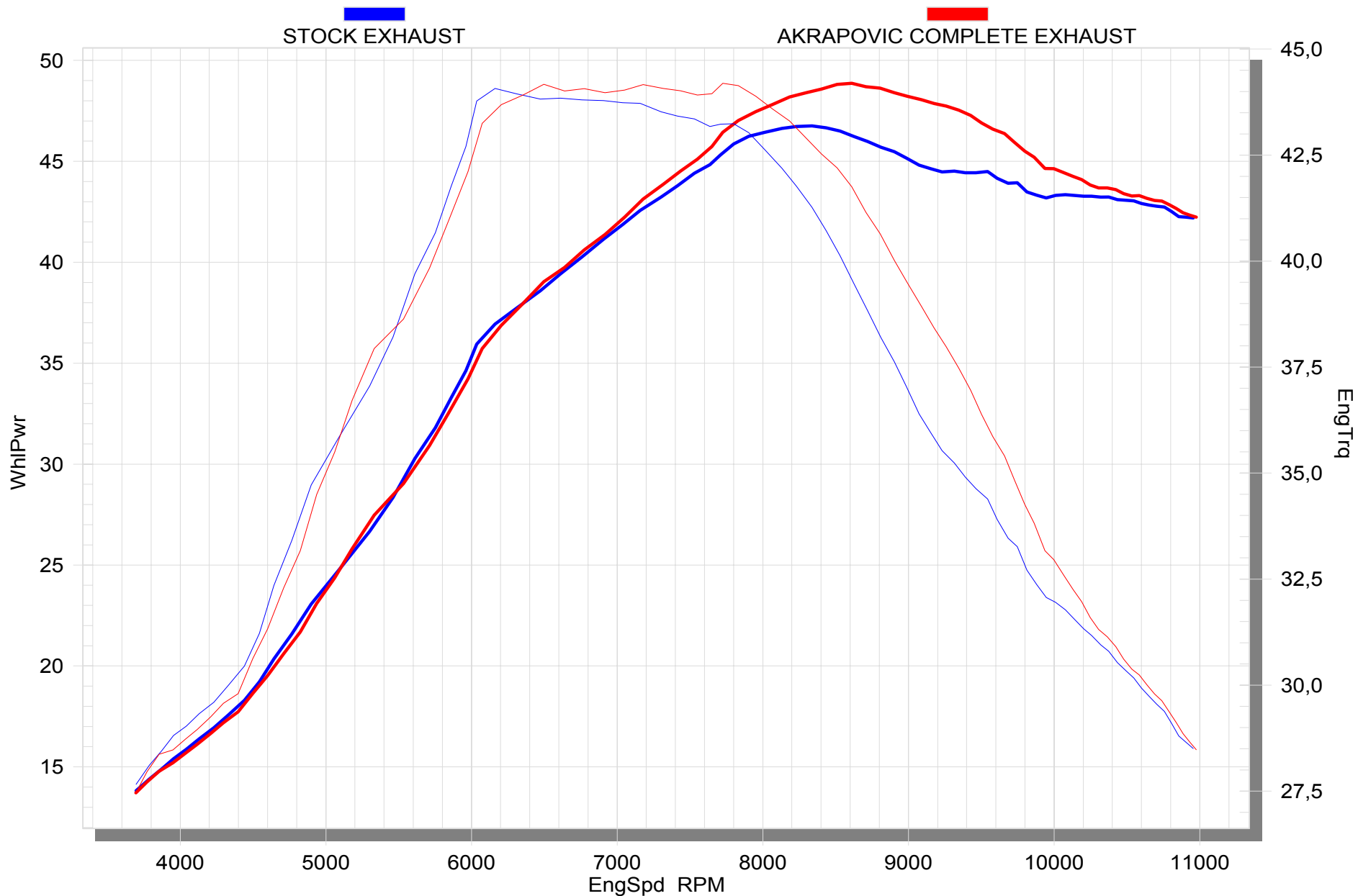

Product code: S-Y4MR8-QT racing, S-Y4MR8-QTA racing US market
 S-Y4MET8-QT evolution, S-Y4MET8-QT evolution US market