



Yamaha YZF R6 (2003)

Slip-on Exhaust System

# Akrapovic Slip-On Exhaust System

for the Yamaha YZF R6 (2003)

The new Yamaha YZF R6. Its design is 90% new or changed from the previous model. What this 90% will bring to the track against this year's tough competition in the Supersport class remains to be seen. The R6 is once again an elegant warrior, with even sharper lines which will catch the attention of even the less interested onlookers. We believe that there are going to be a lot of very satisfied customers who will enjoy its capacities to the limit.

## GOAL

If the size of the stock muffler is a little too big for you, we have developed an Akrapovic SLIP-ON aftermarket component which will elegantly replace the stock muffler. Your R6 will get a face-lift, a throatier sound and of course a performance upgrade as well.

## ABOUT AKRAPOVIC SLIP-ON SYSTEMS

The Akrapovic SLIP-ON system is developed by the same team of professionals at the Akrapovic R&D department who develop exhaust systems at the highest level for factory and private SBK and SS teams all over the world.

The Akrapovic SLIP-ON is the first level of exhaust system tuning. Therefore we can categorize it as an aftermarket component made to take the place of the rear end of the R6's stock exhaust.

The SLIP-ON system is an exhaust system configuration made of two main parts: a muffler and a link-pipe. The link pipe connects to the stock header assembly. It is cylindrical and made of high-quality stainless steel. It is connected to both the header assembly and the muffler with free-floating connections held together with silicon-shielded tensioning springs.

**NOTE:** in addition to the springs, a metal clamp, which is included in the Akrapovic SLIP-ON kit, is used to attach the link pipe to the header assembly. On the engine side, the spring is attached to the stock spacer for the lower engine cowling. See INSTRUCTIONS.

The muffler is the first thing that gets the attention of the enthusiast, since it is the most exposed component. The muffler for the SLIP-ON system is the familiar Akrapovic oval. In order to satisfy our customers' aesthetic demands, we offer two versions of the outer sleeve. You can order either the black cross-hatched pattern of carbon-fiber or the metallic sheen of titanium.

Technical specifications of Akrapovic exhaust systems and related products subject to change without notice.

No matter what your choice is, it will affect only the appearance of the exhaust system, while the performance of both options is identical. The metal parts on the interior of the muffler are made entirely of titanium, which keeps the weight to a minimum. The muffler is attached to the stock chassis hanging bracket with the renowned Akrapovic carbon-fiber clamp, which is designed to serve its purpose with maximum efficiency.

**NOTE:** when mounting the muffler with the carbon-fiber clamp, the carbon-fiber clamp is rotated 180 degrees. The stock nut, bolt and washers are used. See INSTRUCTIONS.

## Measurements of the Akrapovic SLIP-ON system on the Yamaha YZF R6:

### •power:

The Akrapovic SLIP-ON system is not designed to pull the absolute maximum out of the engine; we have other systems in our range which will do that. However, even with this first-level component you will receive a boost in power. It starts around 3000 rpm and stays higher than the stock curve all the way to the top of the rpm range. With the Akrapovic SLIP-ON system you get an extra 1.8 HP at 12700 rpm, which puts 106.4 HP into the rear wheel of your Yamaha.

### •torque:

We managed to increase the torque from 3000 to 4000 rpm, after which the Akrapovic torque curve is identical to the stock curve until 4800 rpm. Above that, the Akrapovic curve exceeds the stock figures all the way to the top of the range.

The elegance of the Akrapovic SLIP-ON package will please those riders who are relatively satisfied with the stock characteristics of the R6, except for the bulky stock muffler. The carbon-fiber outer sleeve goes especially well with the matte black aluminum frame of the R6. The enhanced sound which the engine receives from our system will also turn a lot of Yamaha lovers' heads in your direction.

The Akrapovic SLIP-ON system gives you a taste of the racing scene which fits well with the Yamaha R6. You also get increased performance and a high-tech approach to both production and materials selection. The Akrapovic sticker on the muffler is the signature which guarantees the quality of the world-famous Akrapovic brand.

	stock	AKRAPOVIC		difference	
		S.S.	titanium	stock - S.S.	stock - titanium
weight comparison	3.70 kg	2.0 kg	-	1.70 kg	-
max. rear wheel power	104.6 / 12700 RPM	106.4 HP / 12700 RPM		3 HP / 7900 RPM*	
noise measurement	93.5 db / 6500 RPM	100.4 db / 6500 RPM		6.9 db / 6500RPM	
legal for street use	NO				

\*MAXIMUM MEASURED POWER DIFFERENCE

Akrapovic Exhaust System Technology copyright 2003, all rights reserved

Road Program



# Akrapovic Slip-On Exhaust System for the Yamaha YZF R6 (2003)

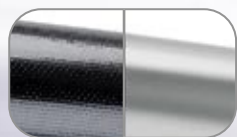

The outer sleeve is available in carbon-fiber or titanium



CARBON-FIBER  
MUFFLER CLAMP

Product code: S-Y6SO3-C, S-Y6SO3-T

# Akrapovic Slip-On Exhaust System for the Yamaha YZF R6 (2003)



Akrapovic Exhaust System Technology copyright 2003, all rights reserved

Road  
Program

Product code: S-Y6SO3-C, S-Y6SO3-T

# Akrapovic Slip-On Exhaust System for the Yamaha YZF R6 (2003)



Akrapovic Exhaust System Technology copyright 2003, all rights reserved

Road Program

Product code: S-Y6SO3-C, S-Y6SO3-T

# Akrapovic Slip-On Exhaust System for the Yamaha YZF R6 (2003)

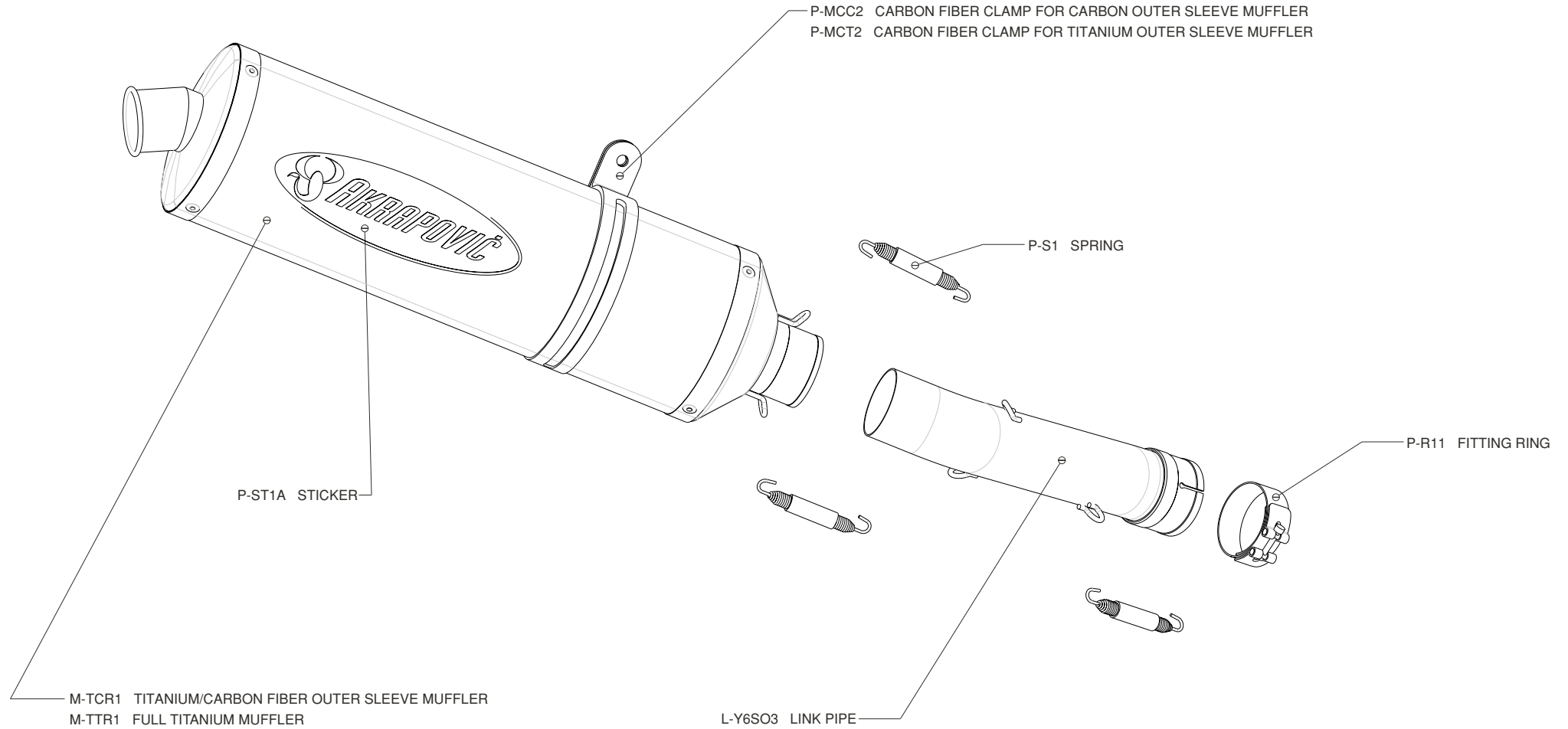

Akrapovic Exhaust System Technology copyright 2003, all rights reserved

Road Program

# Akrapovic Slip-On Exhaust System for the Yamaha YZF R6 (2003)

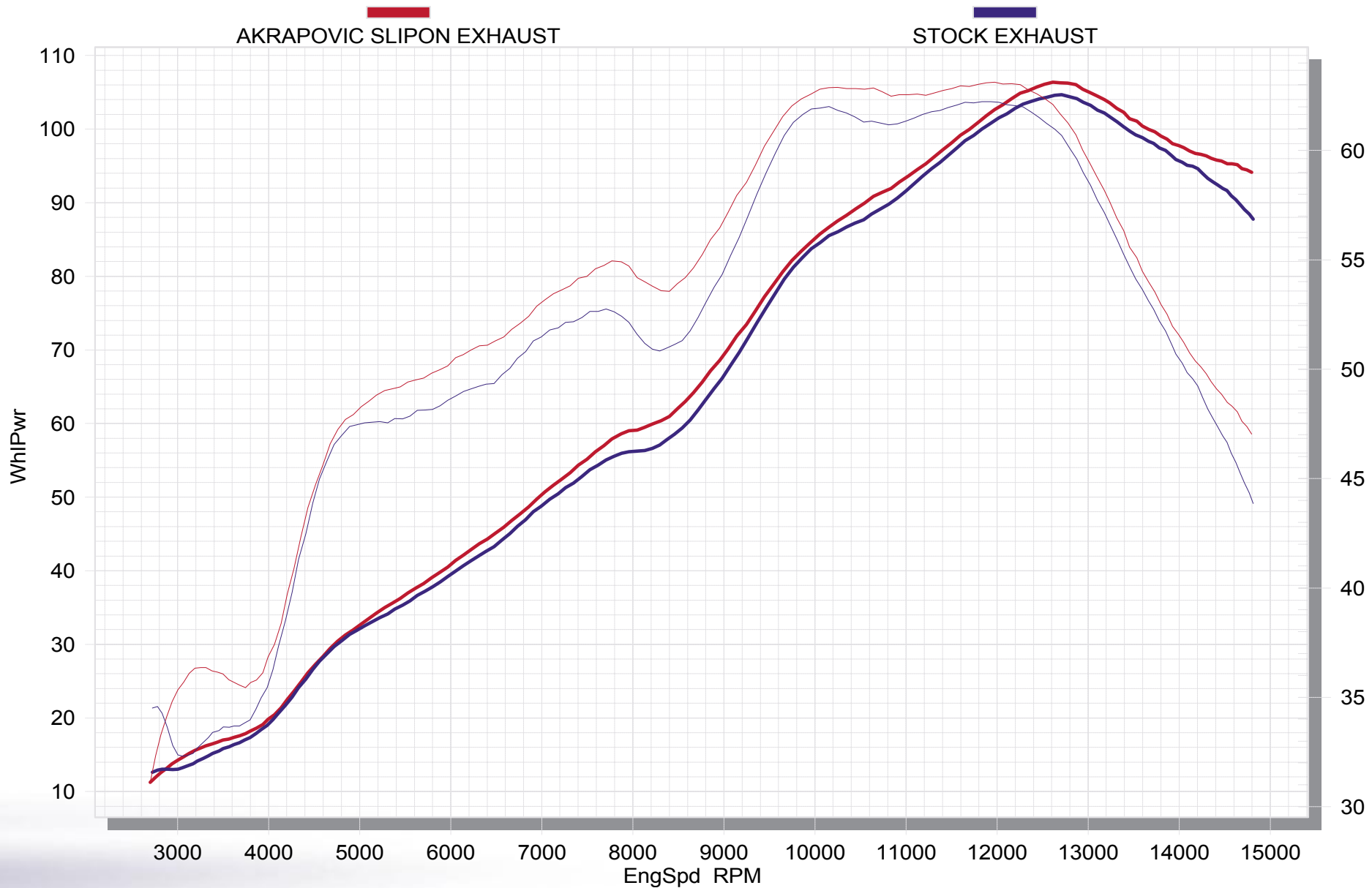

Akrapovic Exhaust System Technology copyright 2003, all rights reserved

Road Program

